

ROOFLOGIC SYSTEM:
ULTRATHERM MSR

DRAWING:
TYPICAL ROOF - 2X ACOUSTIC BOARD

DRAWING NUMBER: 102

DRAWN SCALE: NTS

ROOFLOGIC.CO.NZ

This drawing is the copyright of Rooflogic. Modification of details for job specification requirements must be approved by Rooflogic. The building designer is ultimately responsible to ensure all building work is designed and constructed according to Building Code requirements, NZ standards and best code of practice industry guidelines. All components must be supplied by Rooflogic. Rooflogic reserves the right to alter or upgrade details at any time without prior notice.

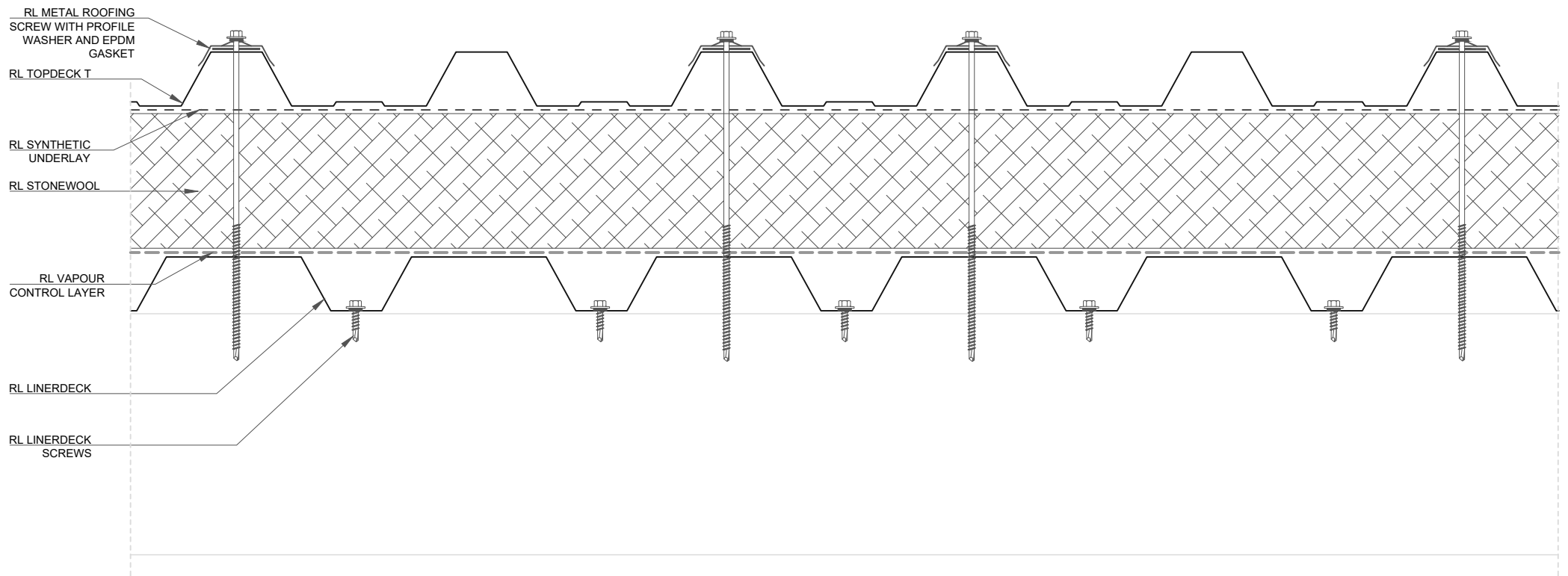

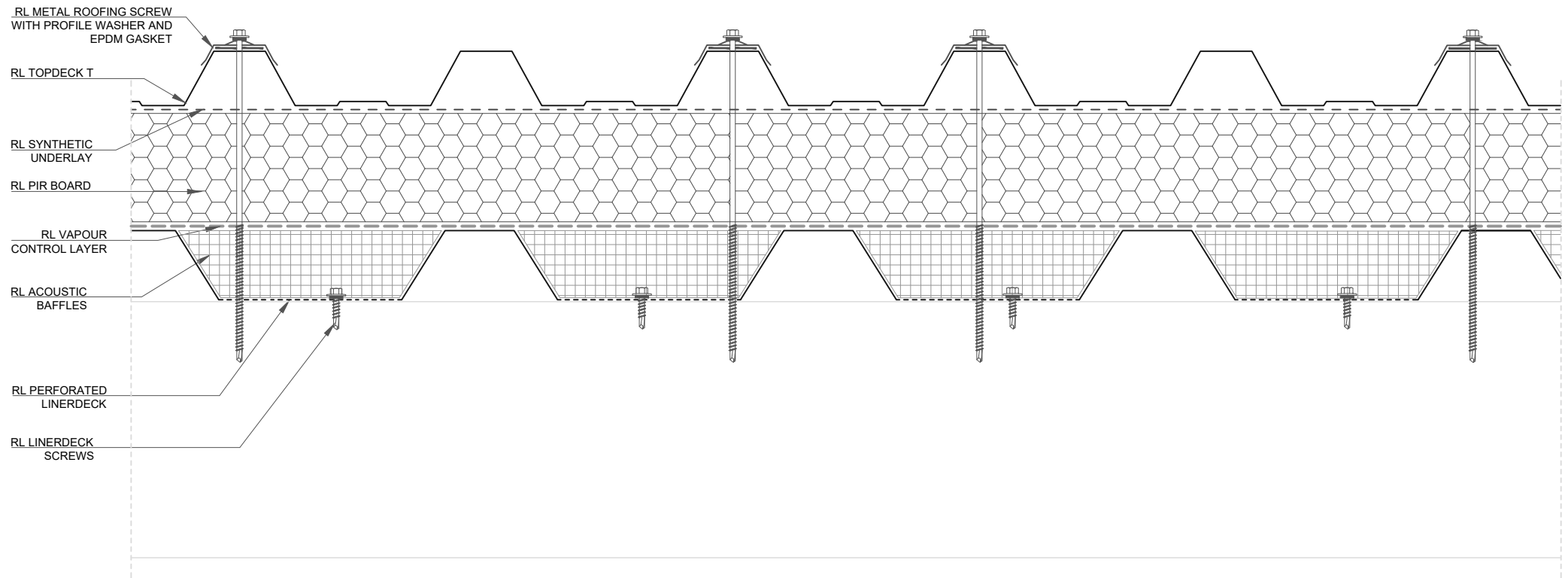

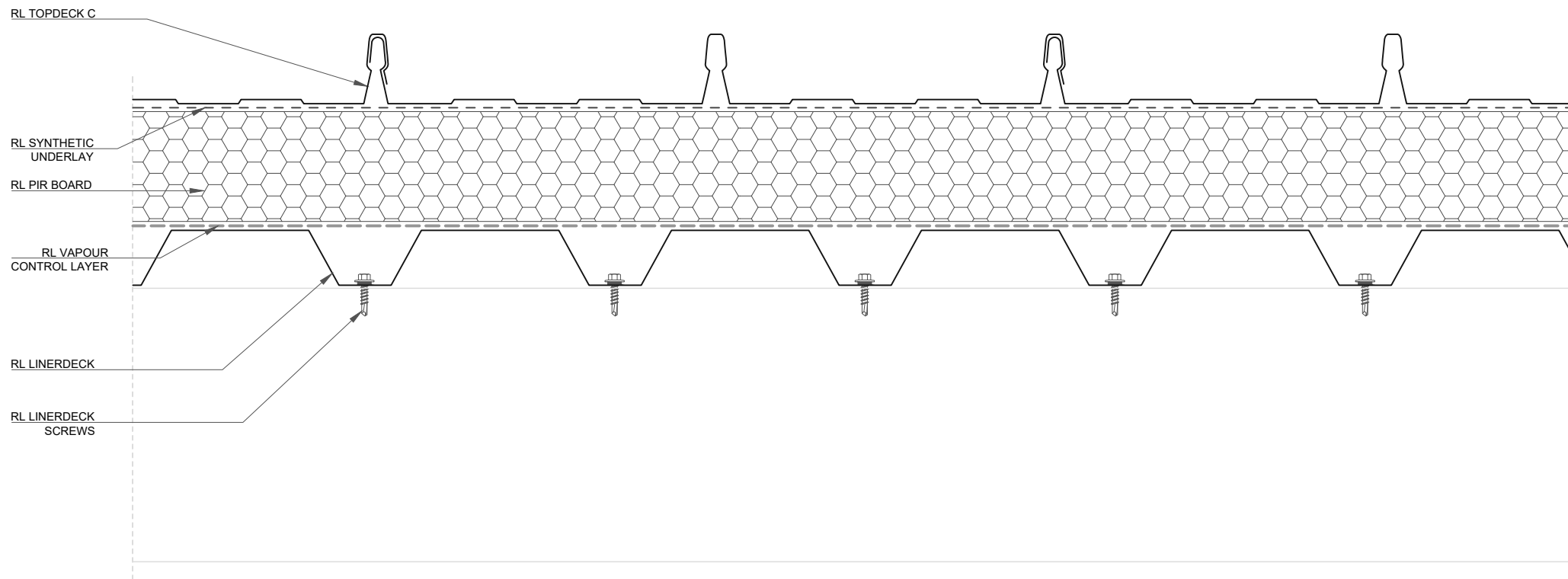

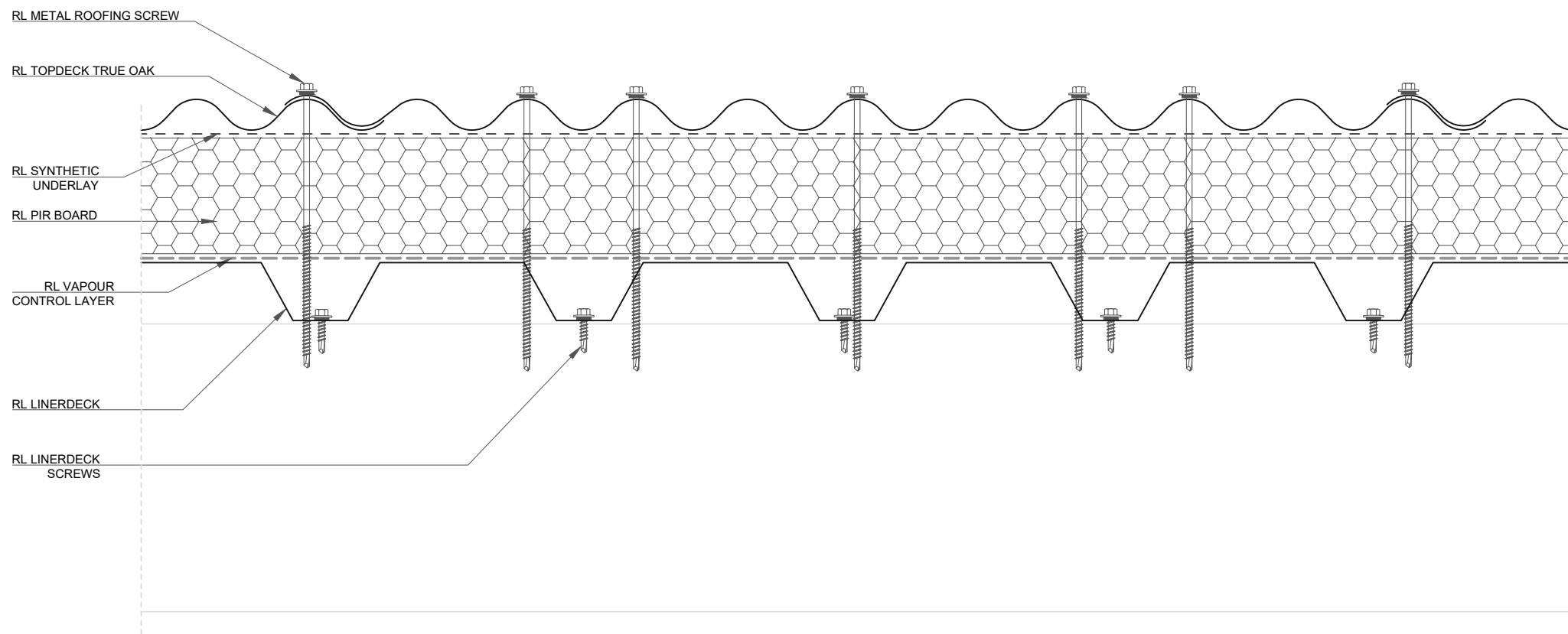

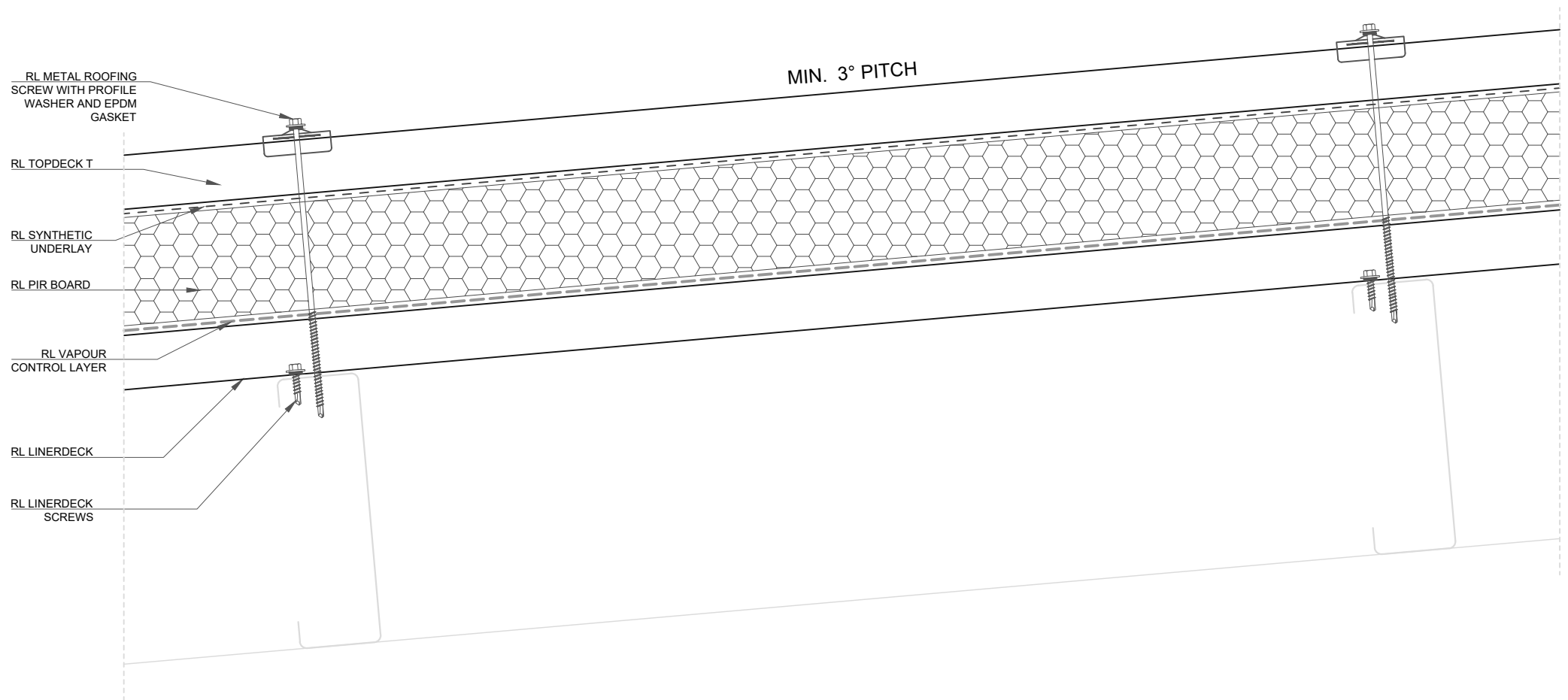

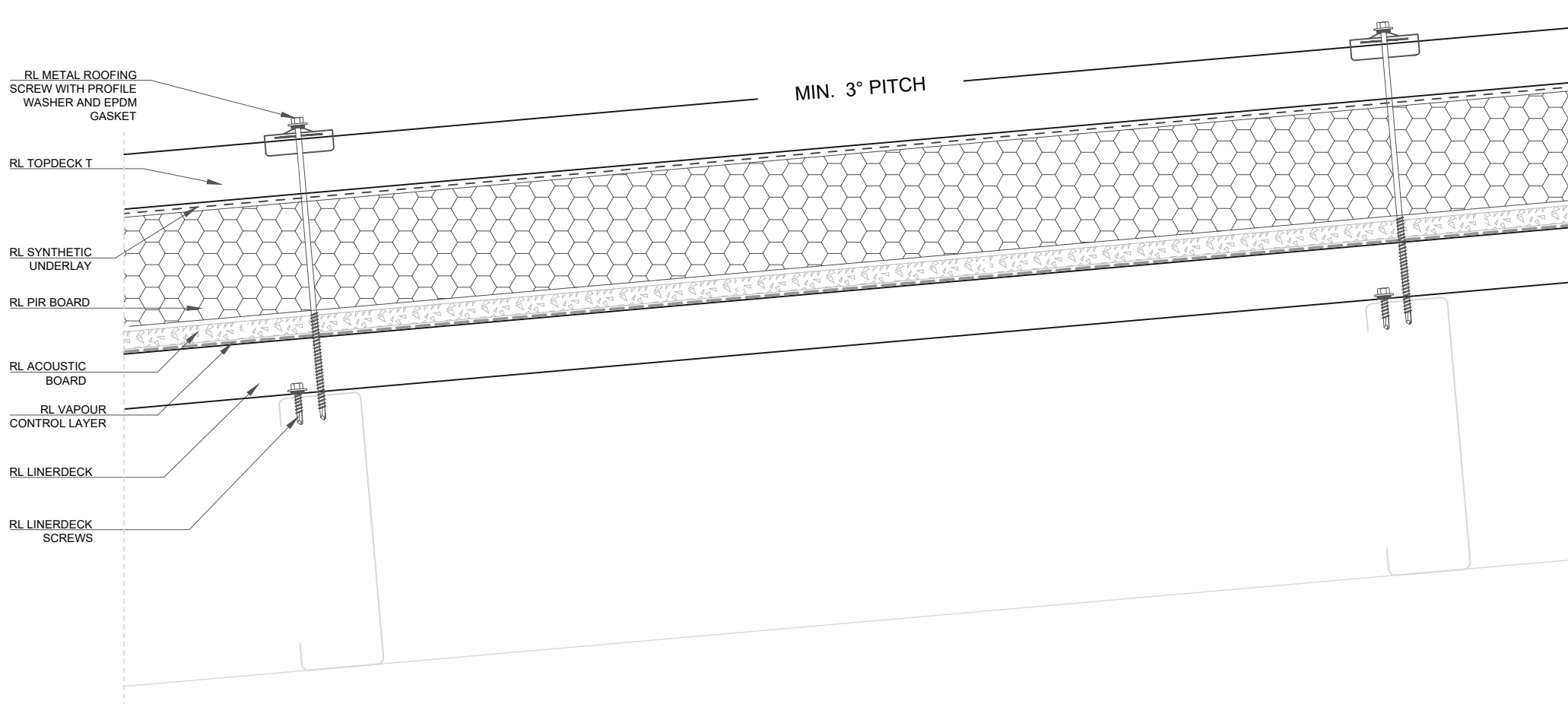

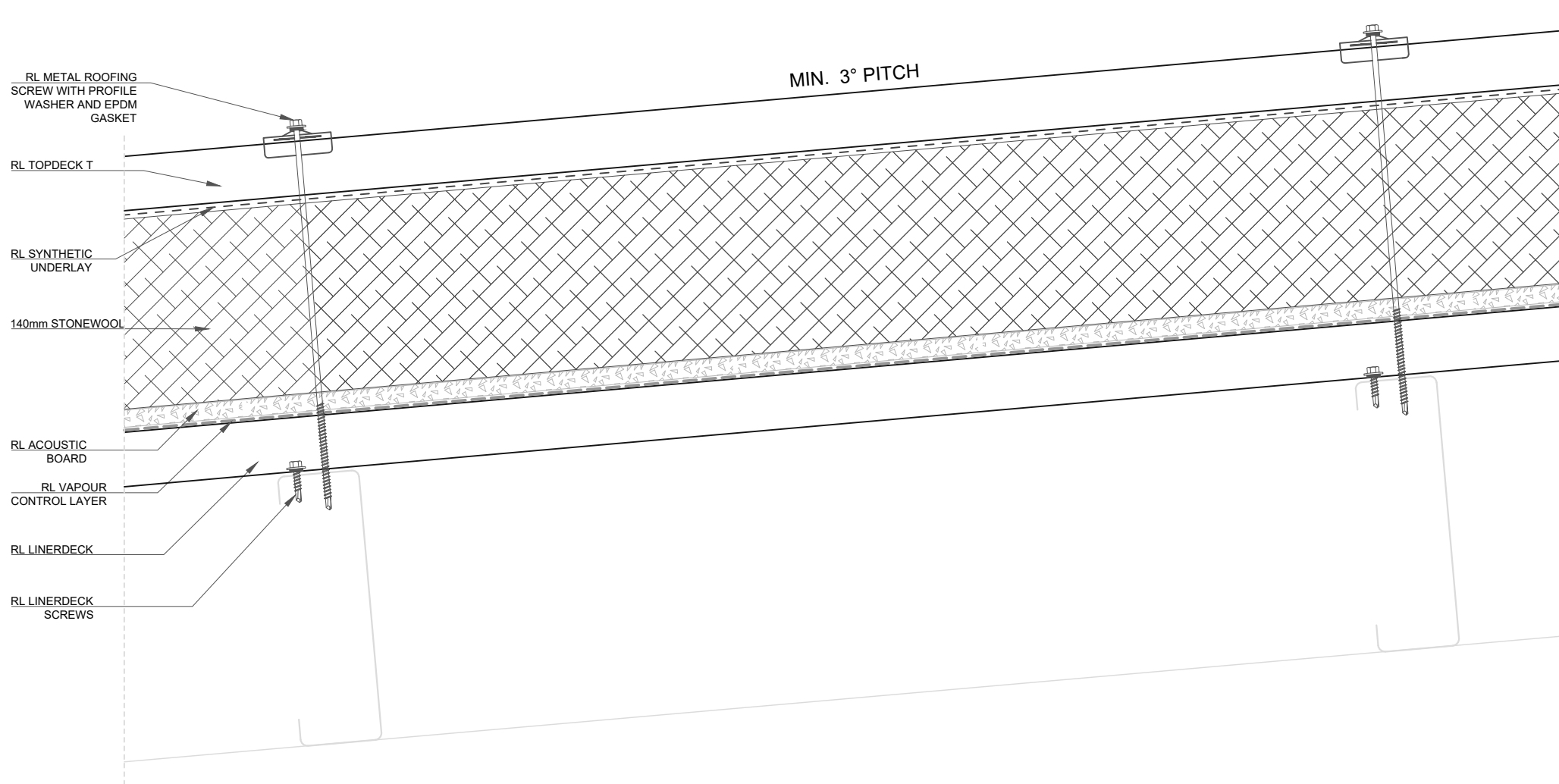

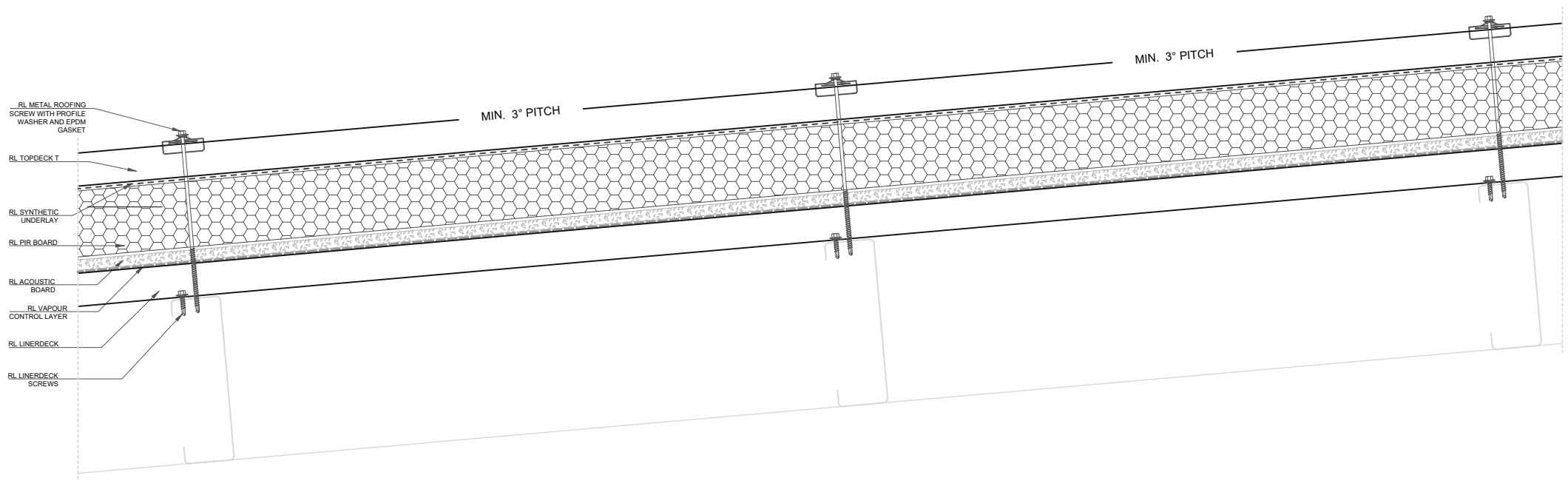

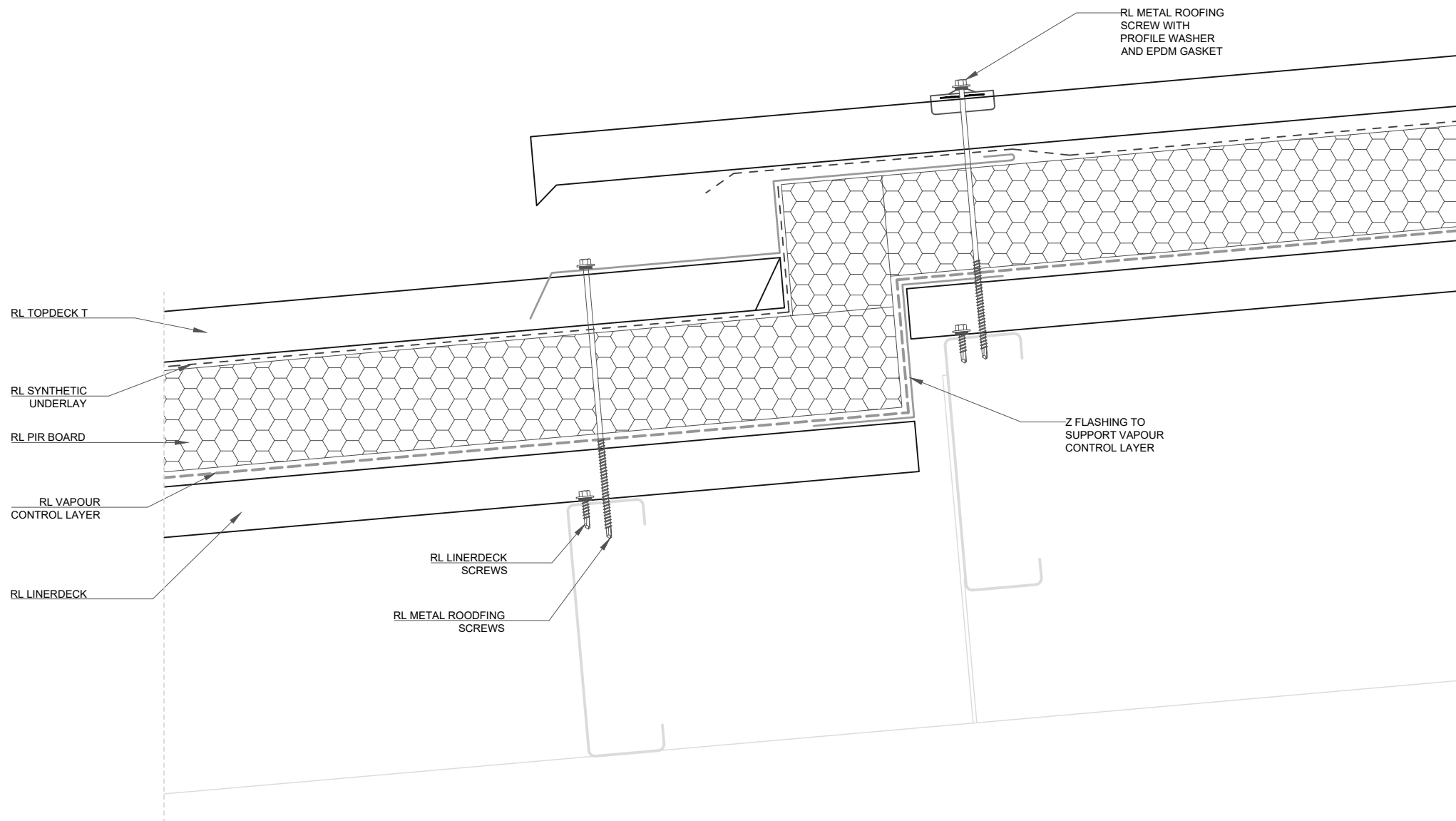

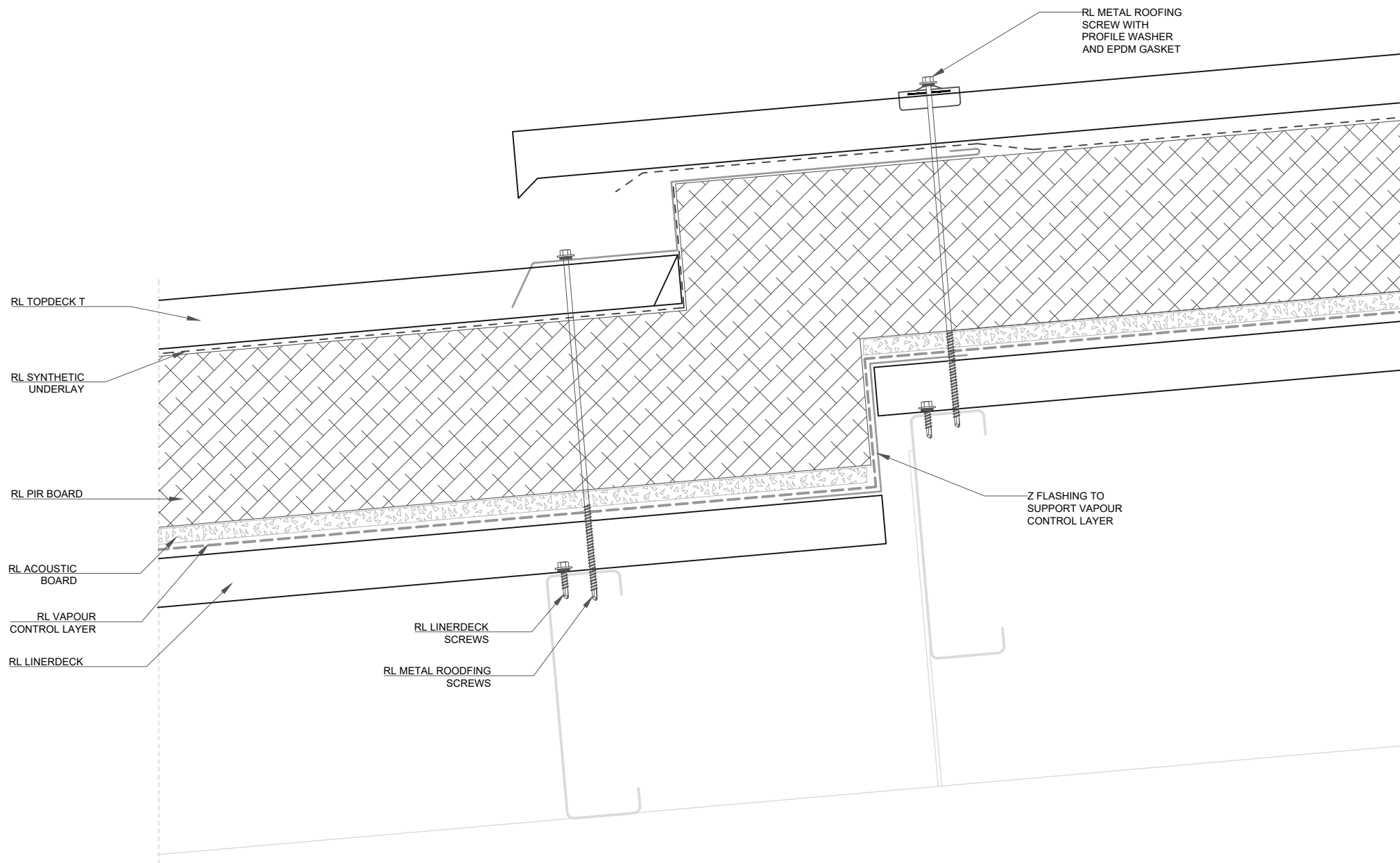

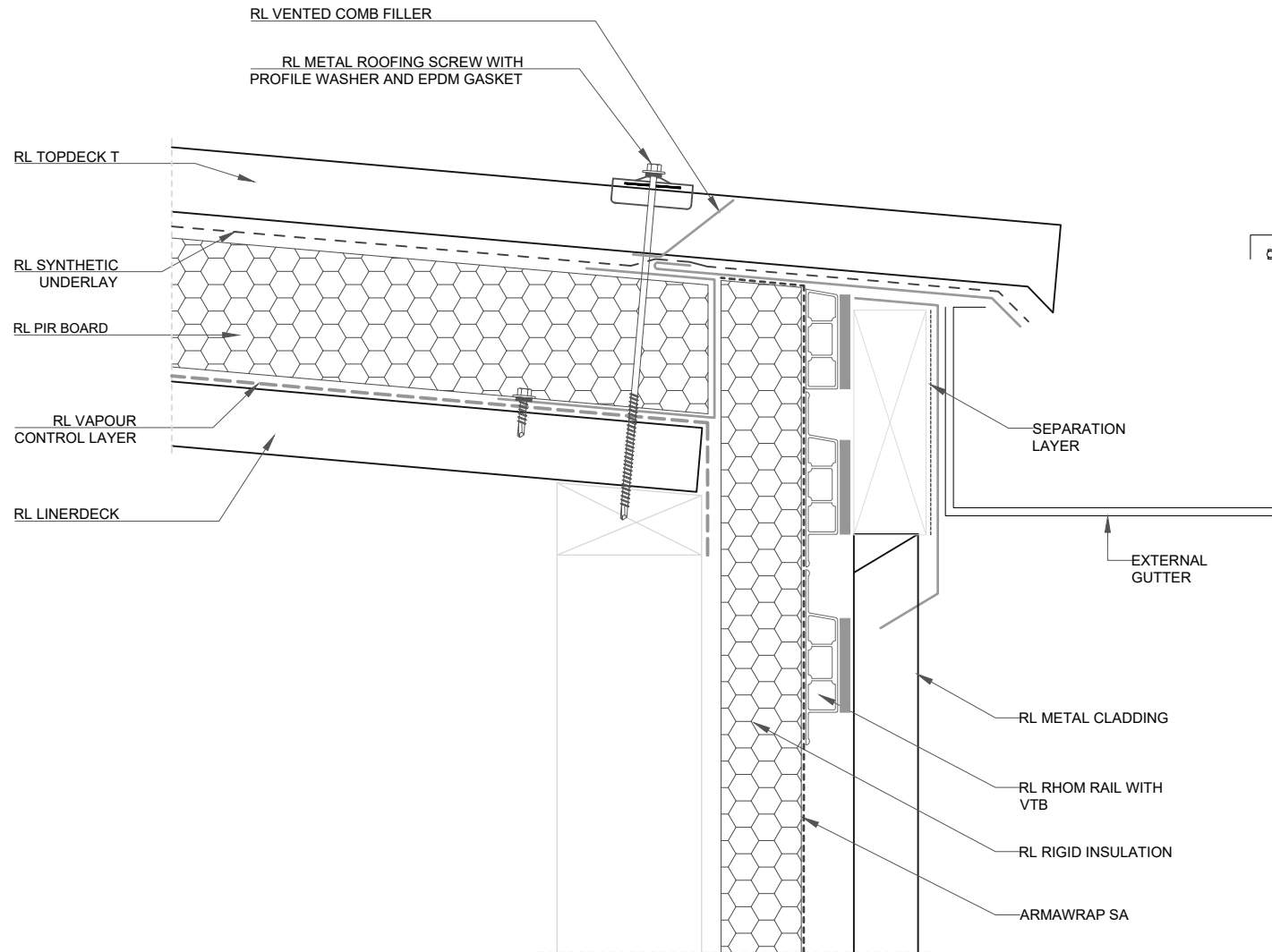

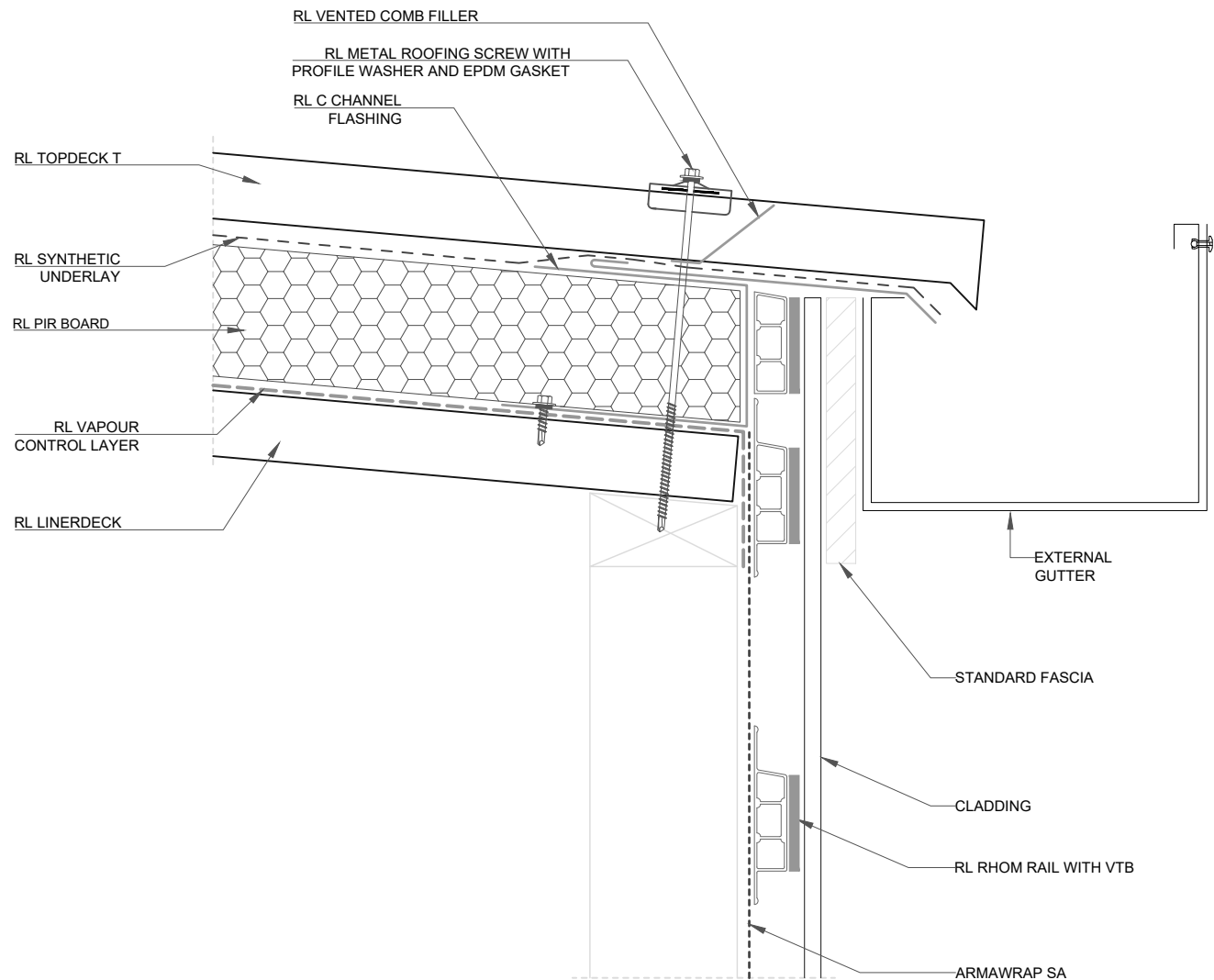

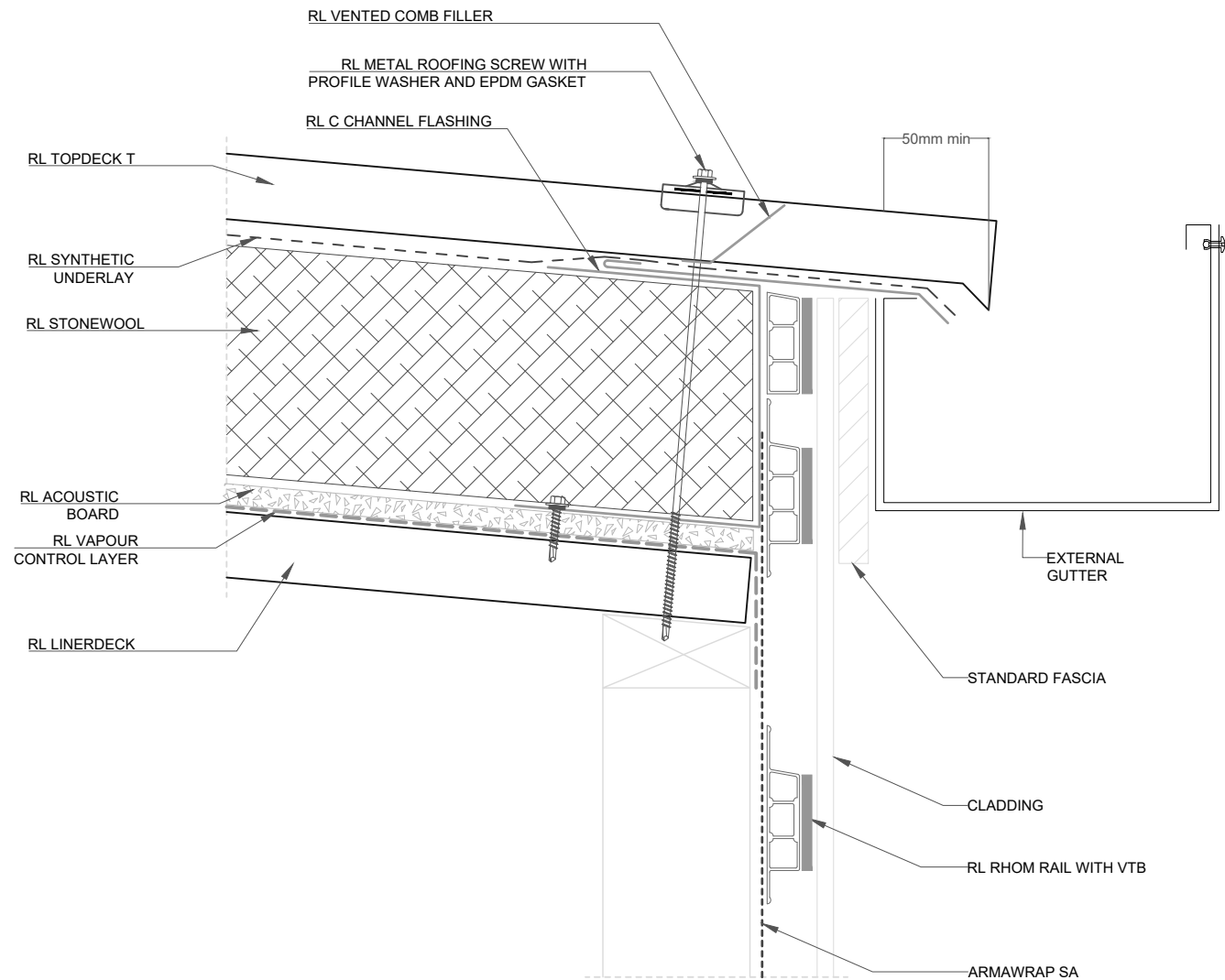

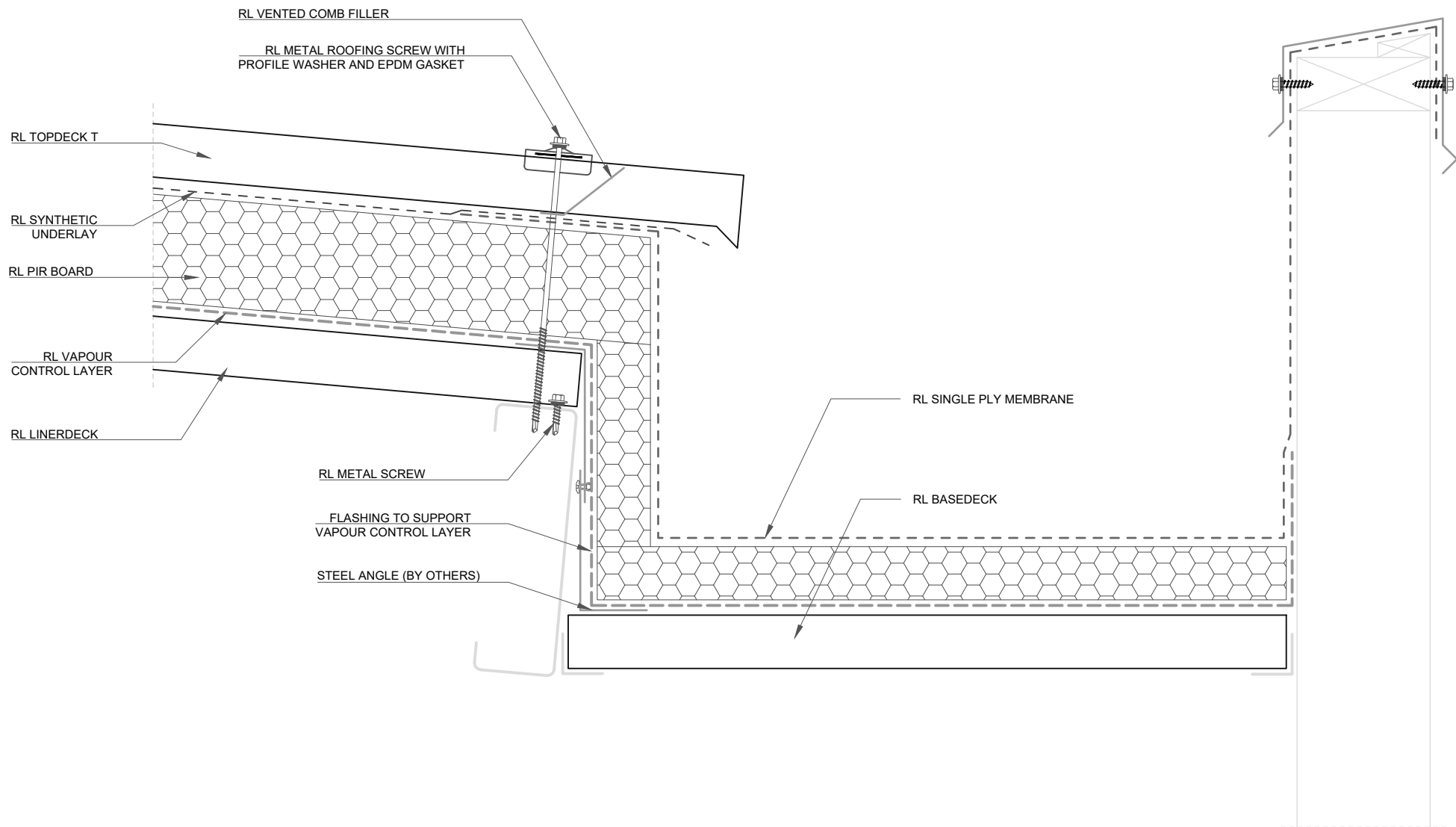

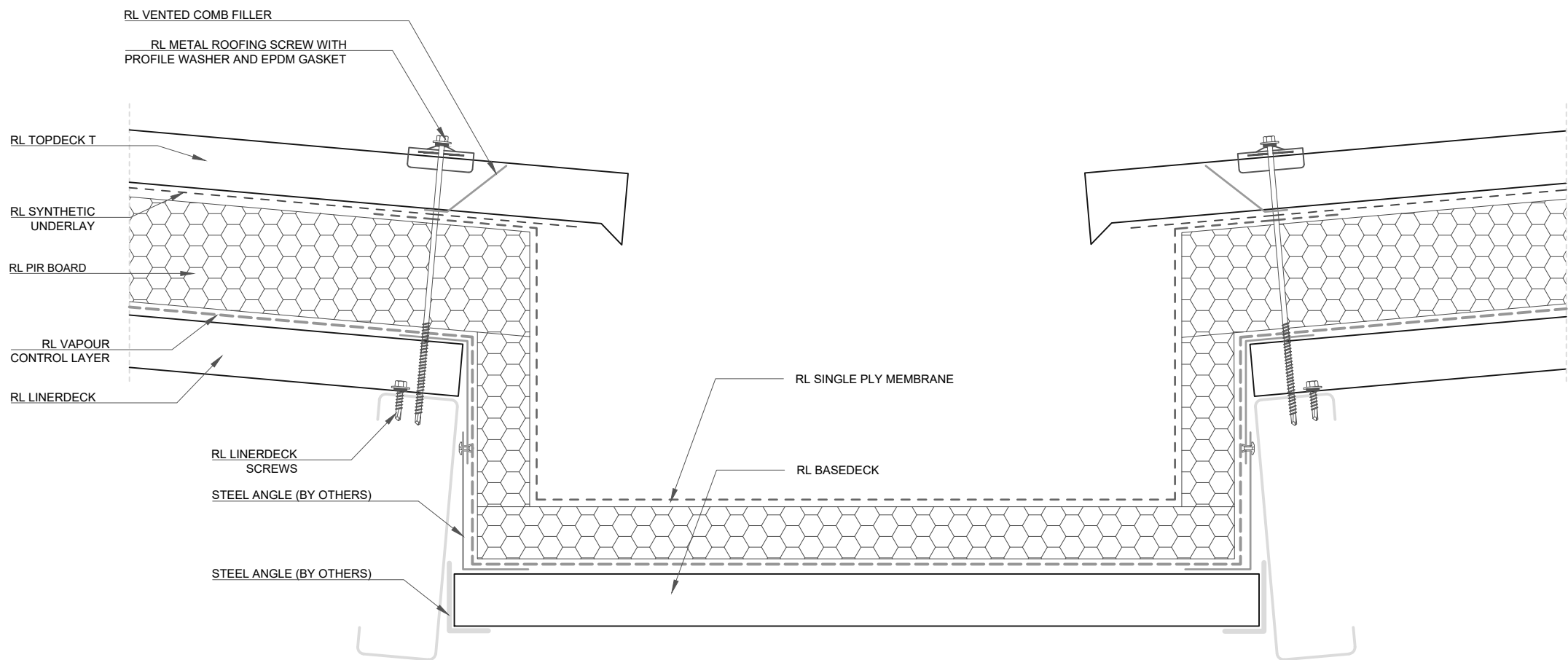

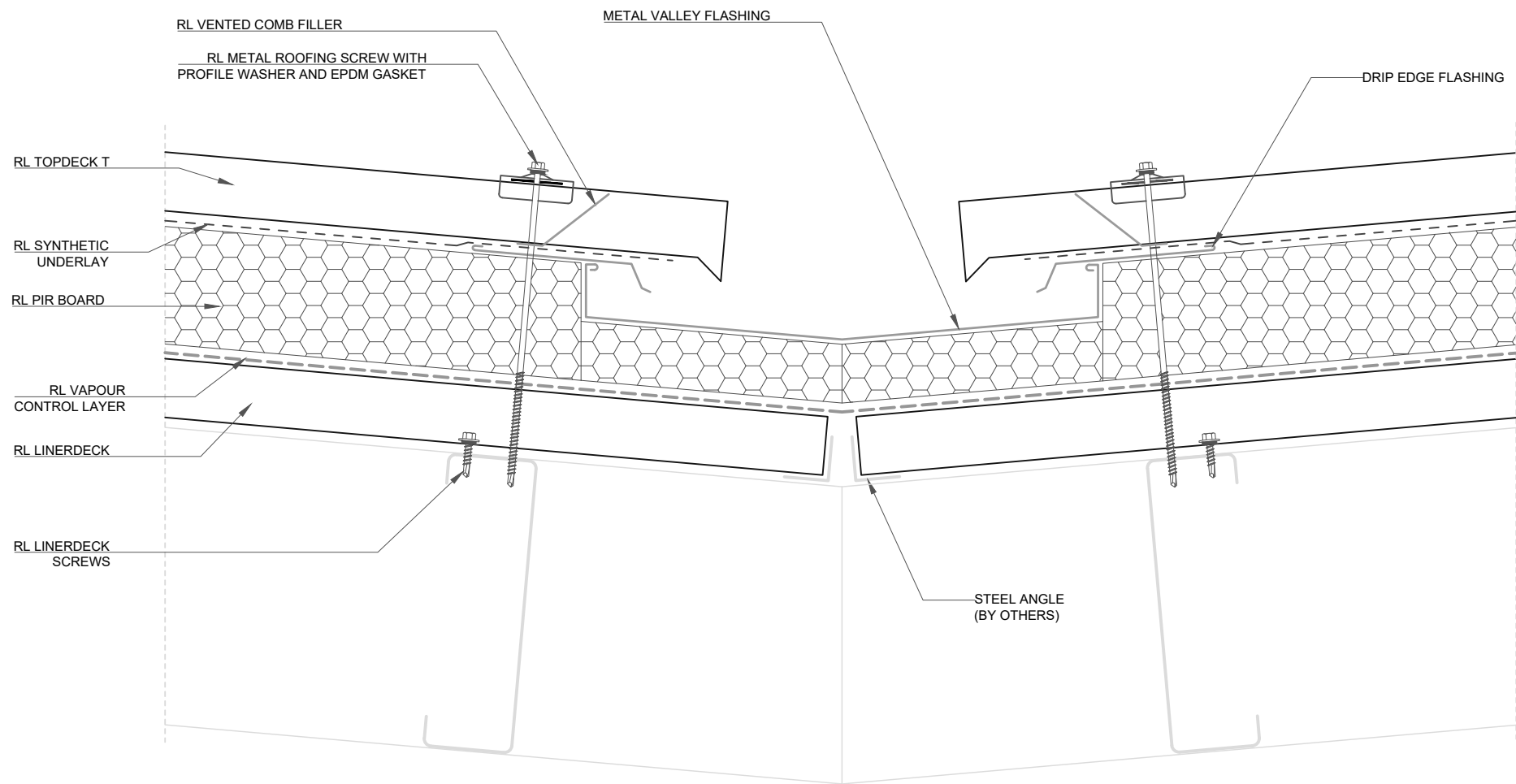

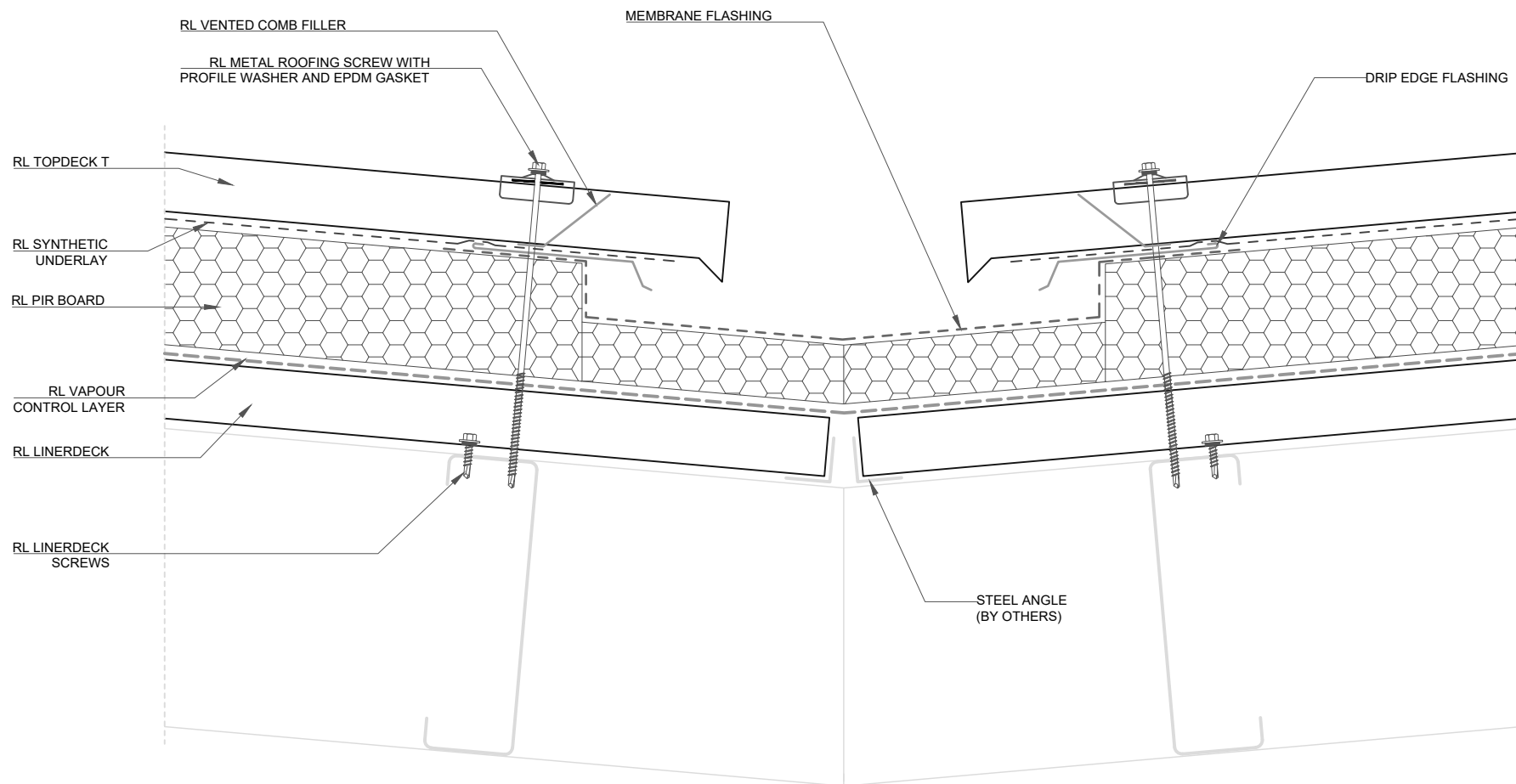

SQUARE TOP RIDGE
FLASHING PURPOSE
MADE TO MATCH
ROOF PITCH

RL METAL ROOFING
SCREW

RL TOPDECK T

RL SYNTHETIC
UNDERLAY

RL PIR BOARD

RL VAPOUR
CONTROL LAYER

RL LINERDECK

RL LINERDECK
SCREWS



ROOFLOGIC SYSTEM:
ULTRATHERM MSR

DRAWING:
TYPICAL RIDGE

DRAWING NUMBER: 400

DRAWN SCALE: NTS

ROOFLOGIC.CO.NZ

This drawing is the copyright of Rooflogic. Modification of details for job specification requirements must be approved by Rooflogic. The building designer is ultimately responsible to ensure all building work is designed and constructed according to Building Code requirements, NZ standards and best code of practice industry guidelines. All components must be supplied by Rooflogic. Rooflogic reserves the right to alter or upgrade details at any time without prior notice.

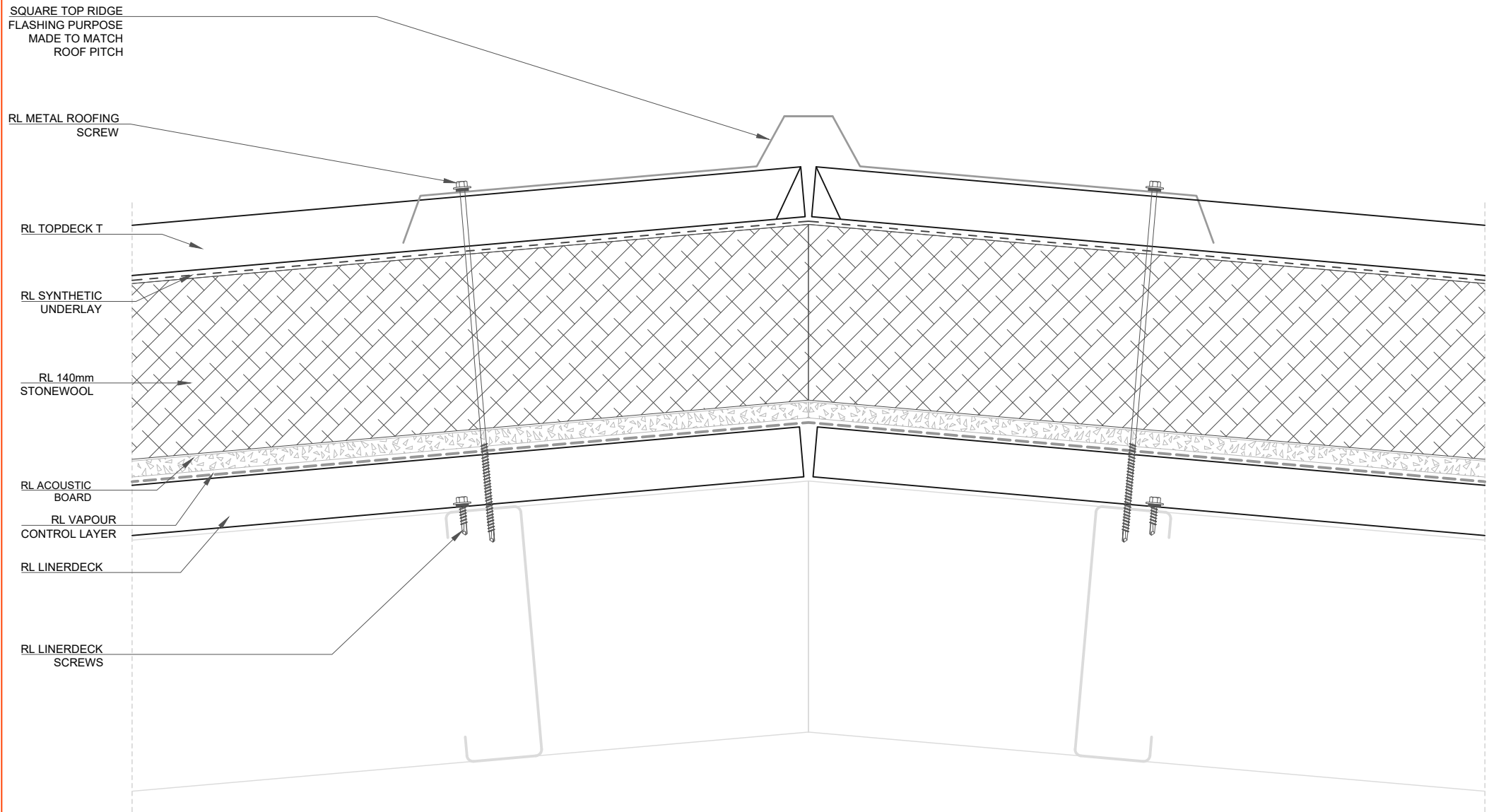

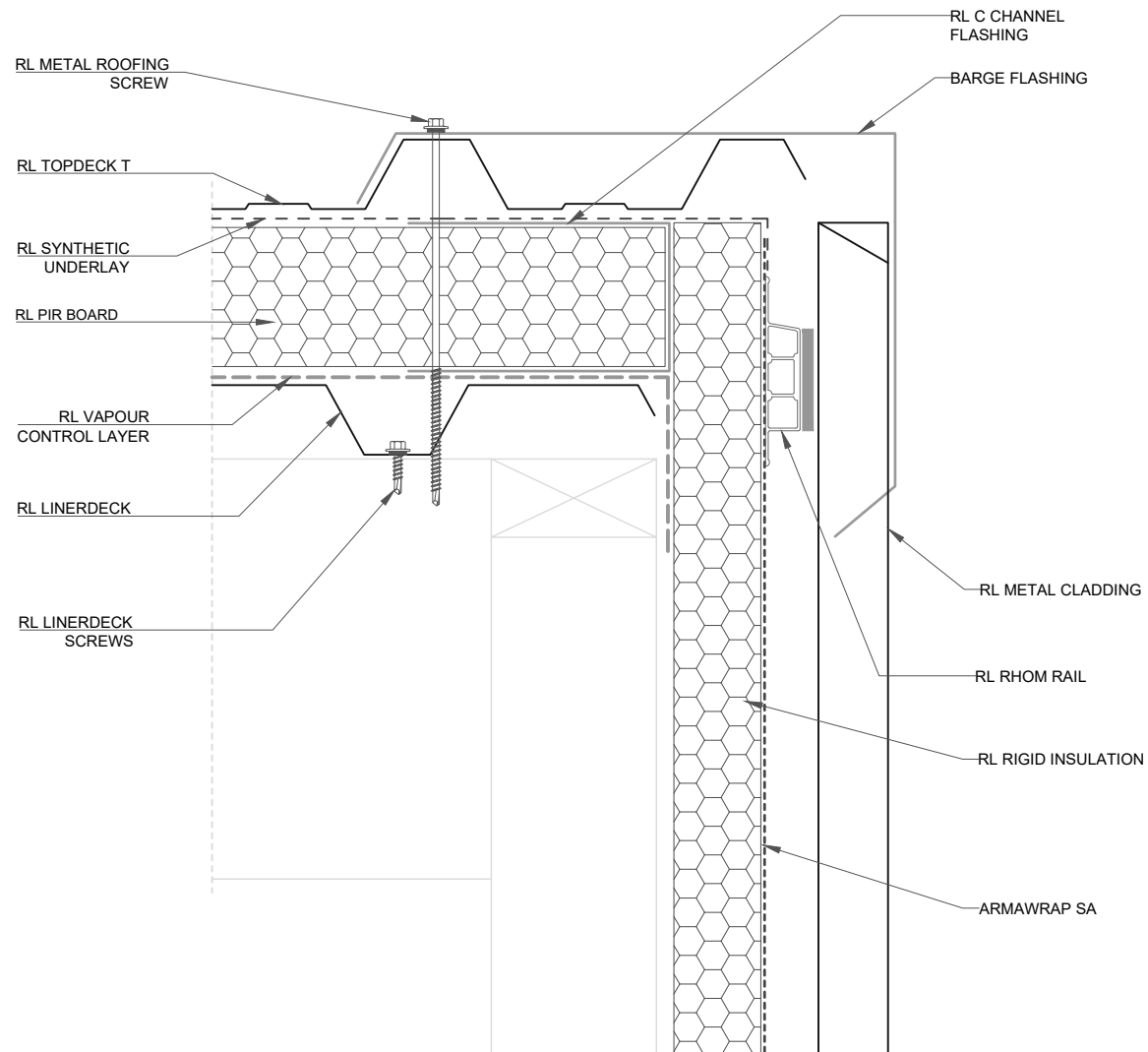

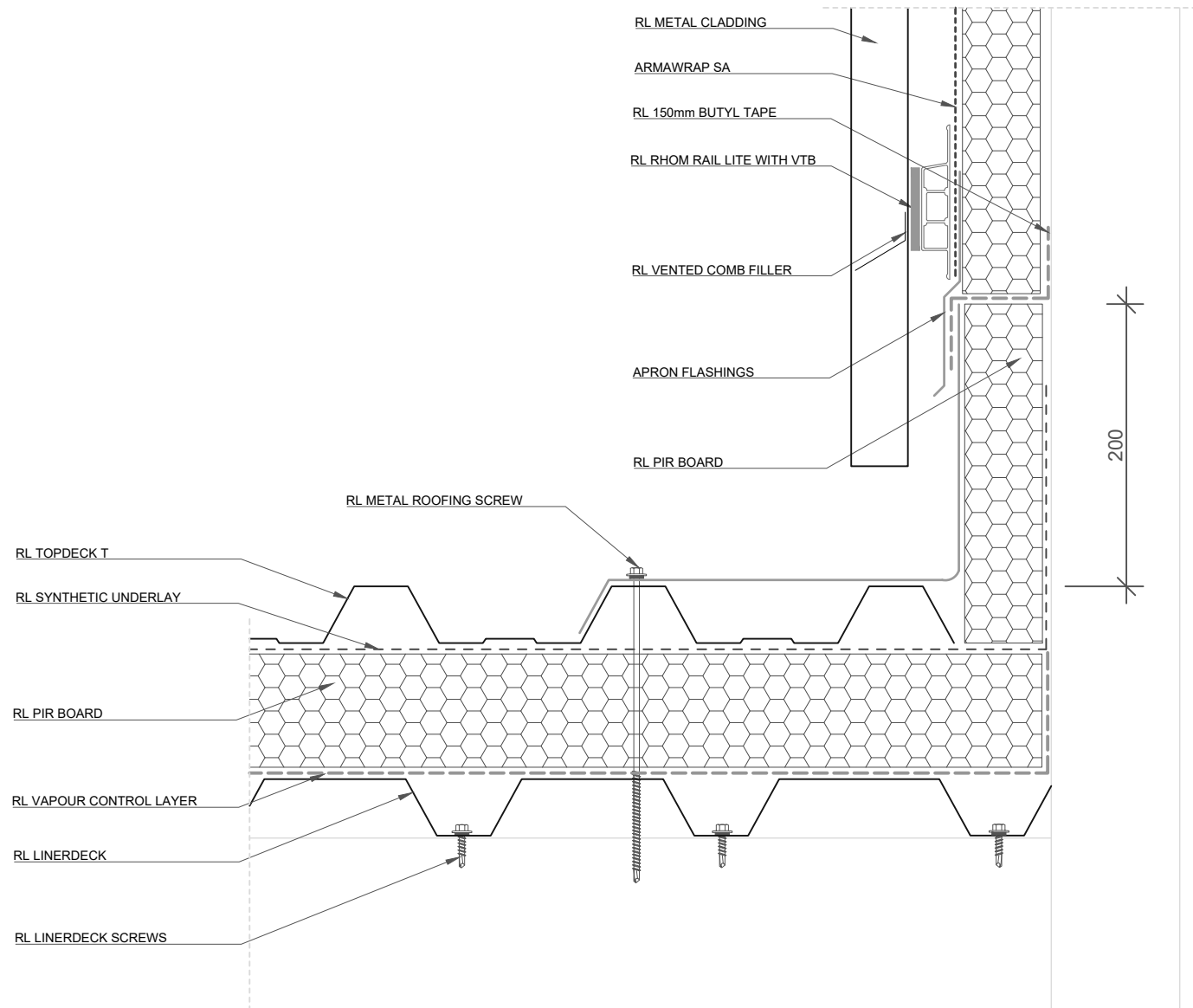

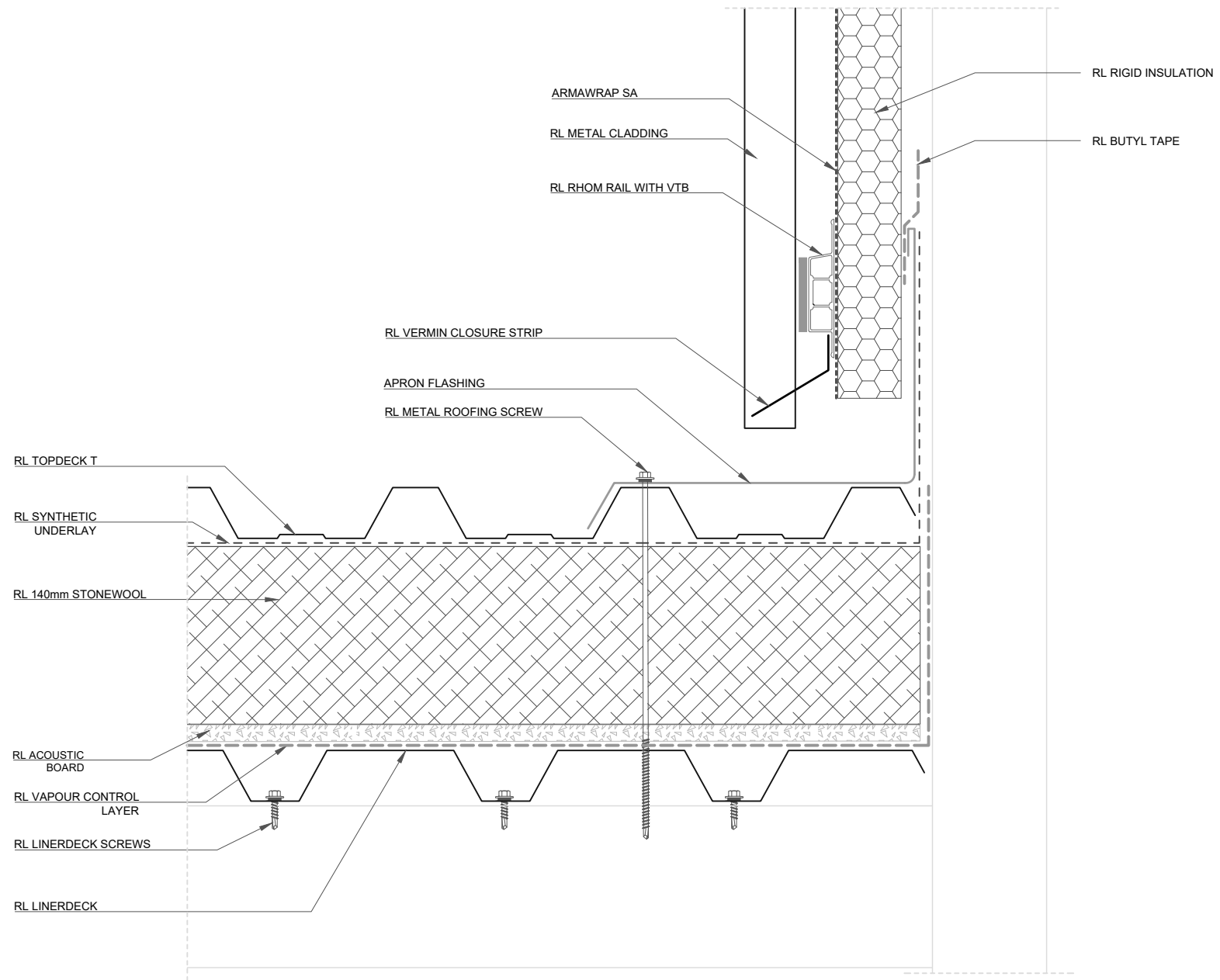

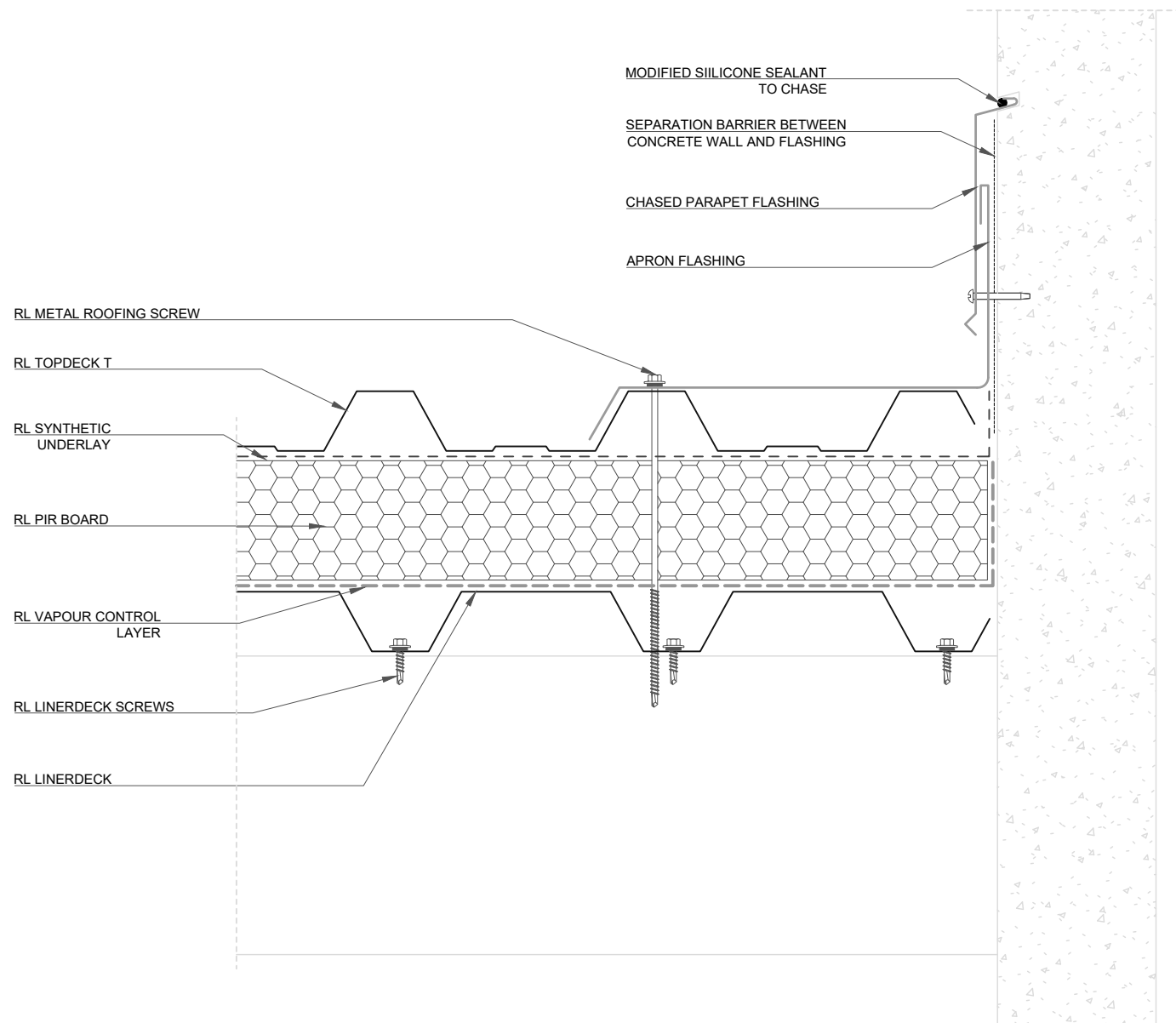

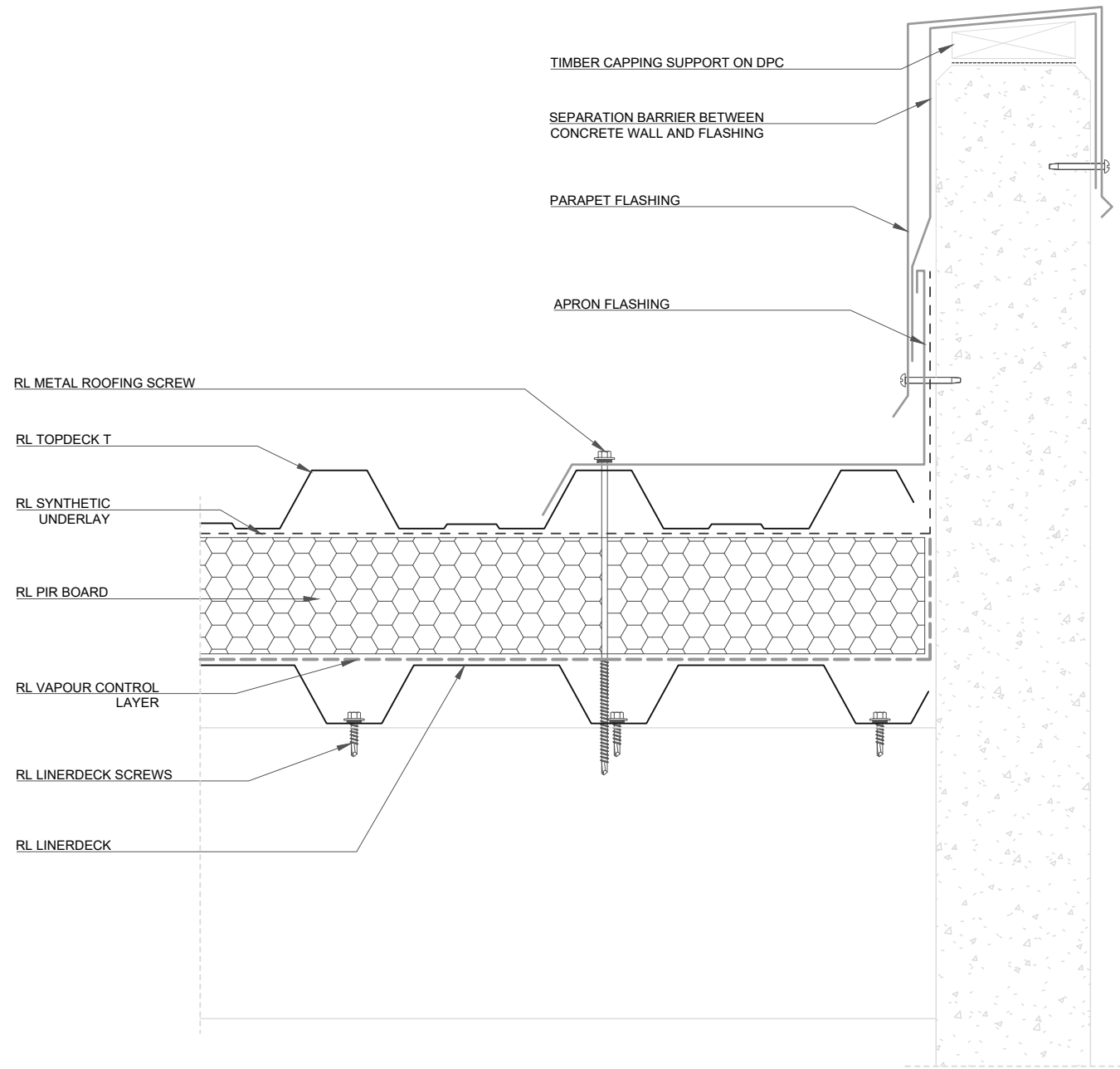

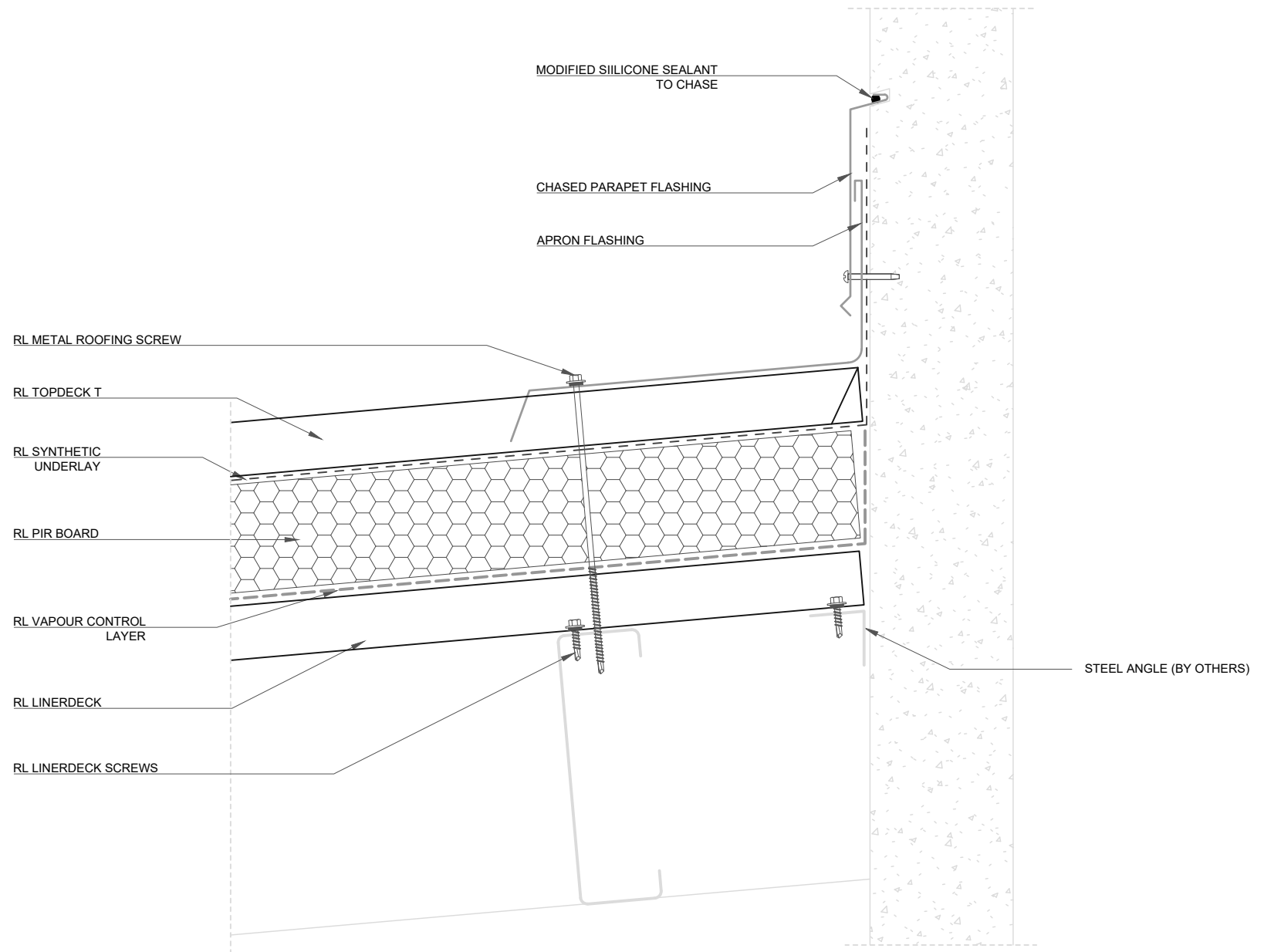

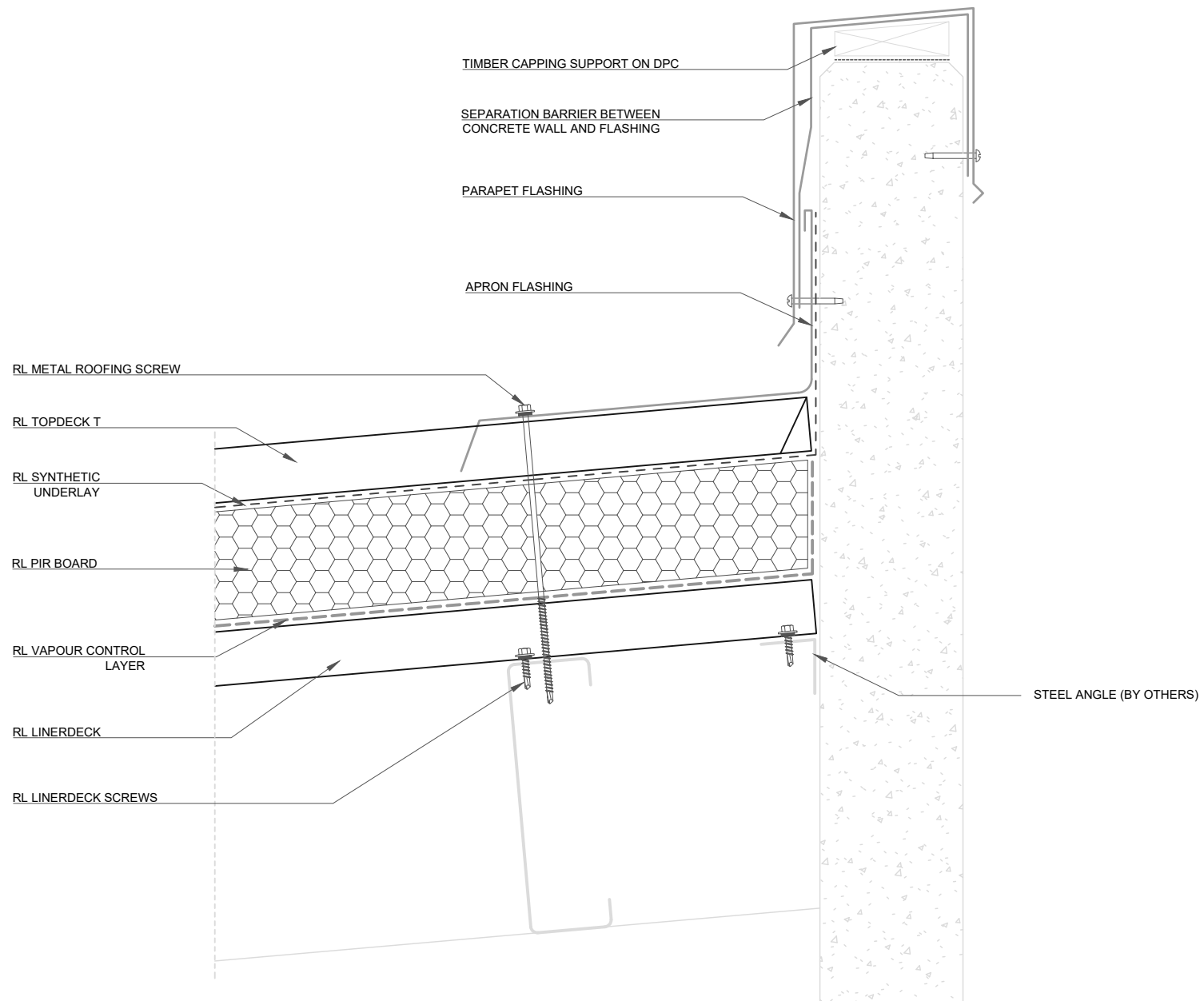

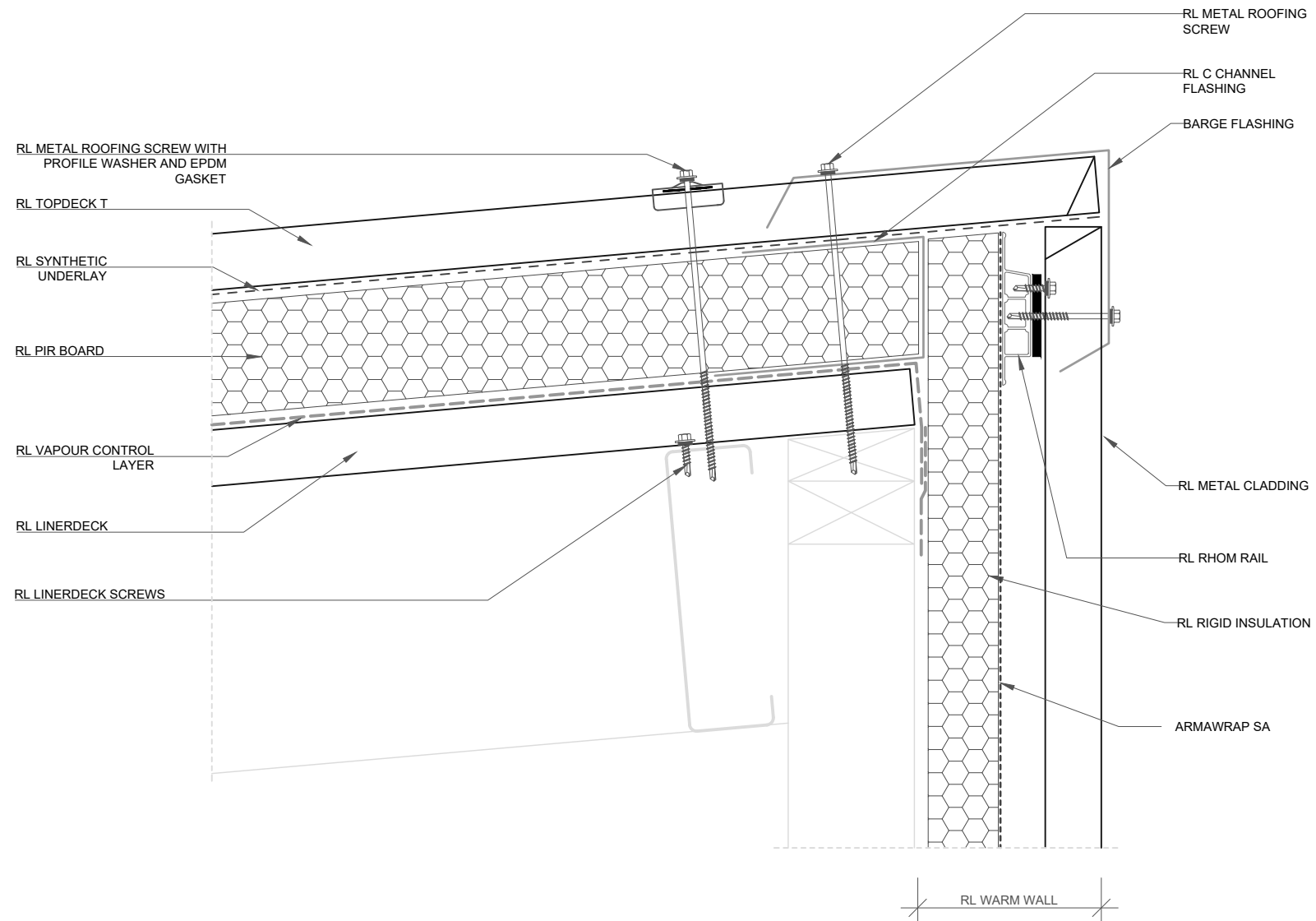

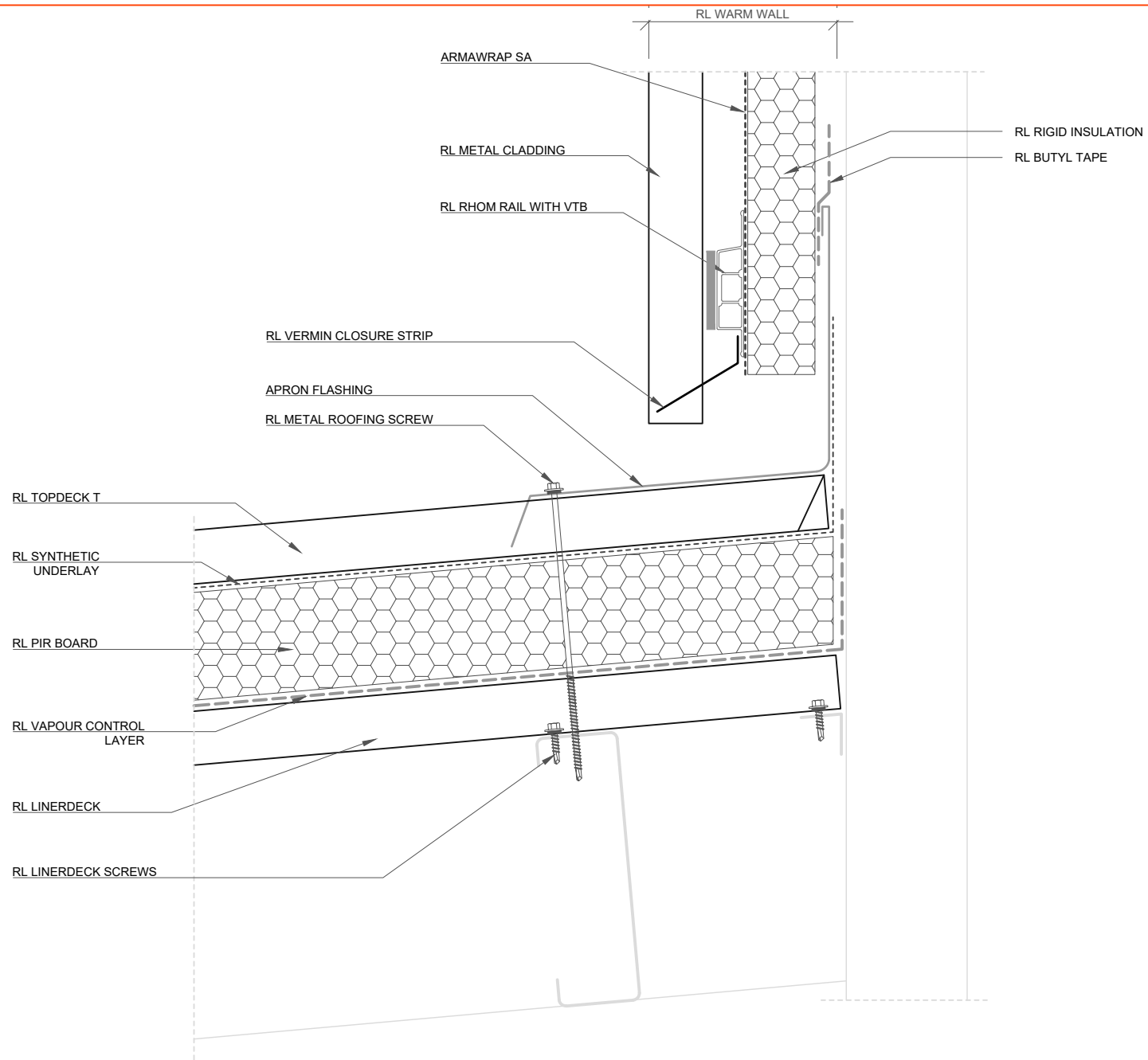

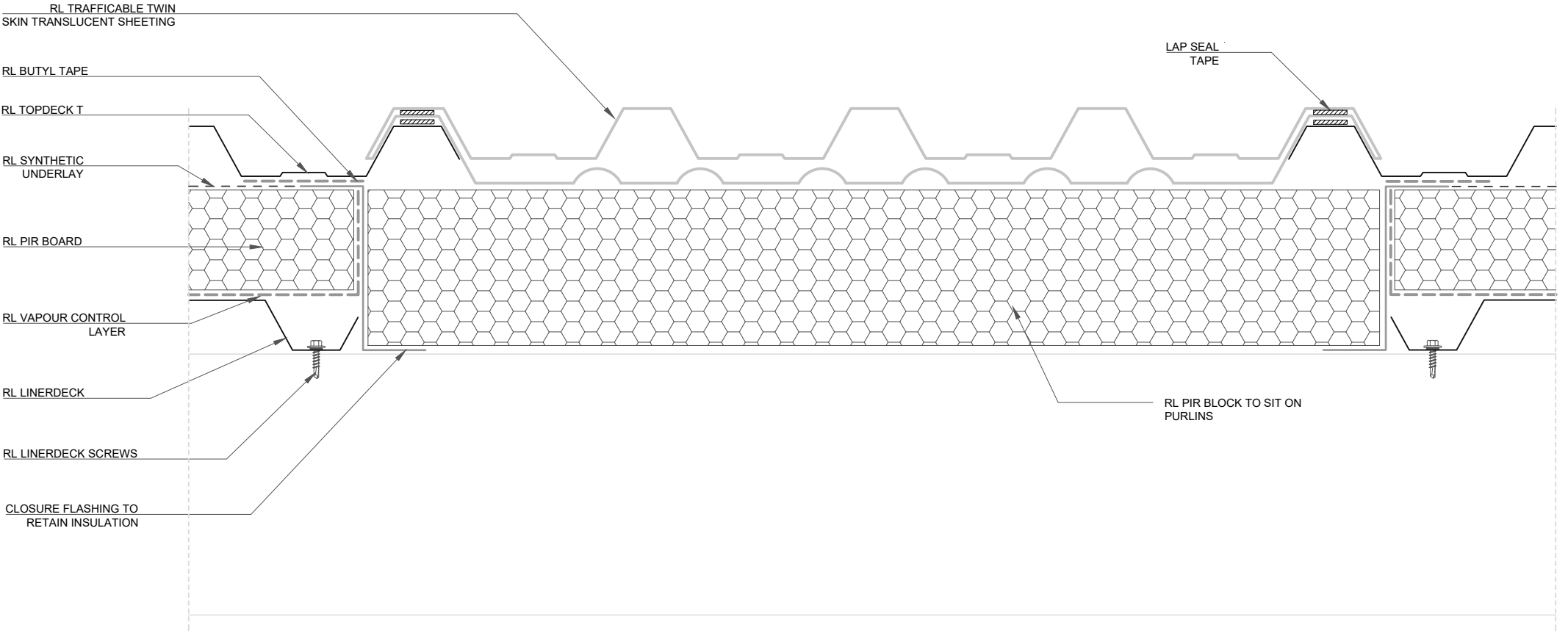

ROOFLOGIC SYSTEM:
ULTRATHERM MSR

DRAWING:
DOUBLE SKIN SKYLIGHT SECTION

DRAWING NUMBER: 500

DRAWN SCALE: NTS

ROOFLOGIC.CO.NZ

This drawing is the copyright of Rooflogic. Modification of details for job specification requirements must be approved by Rooflogic. The building designer is ultimately responsible to ensure all building work is designed and constructed according to Building Code requirements, NZ standards and best code of practice industry guidelines. All components must be supplied by Rooflogic. Rooflogic reserves the right to alter or upgrade details at any time without prior notice.

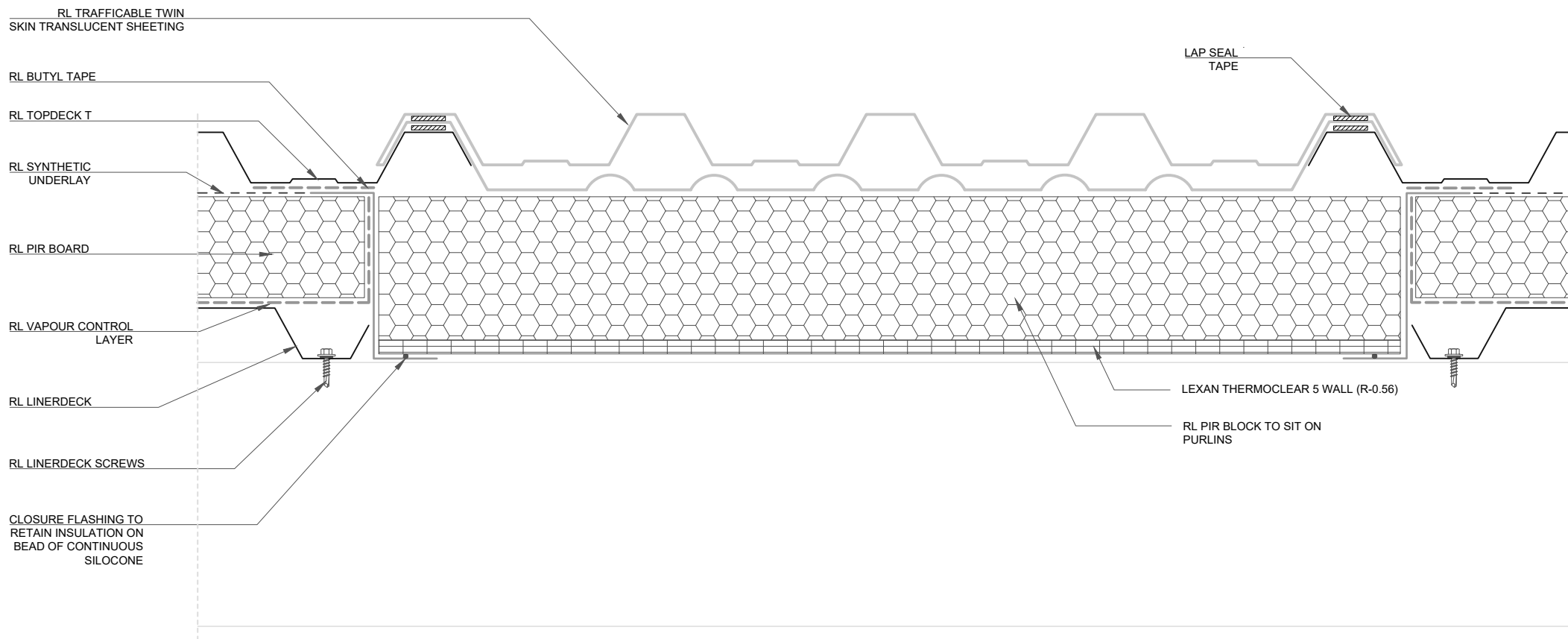

AS-BUILT TEST SETUP - PURLINS PERPENDICULAR TO THE WALL

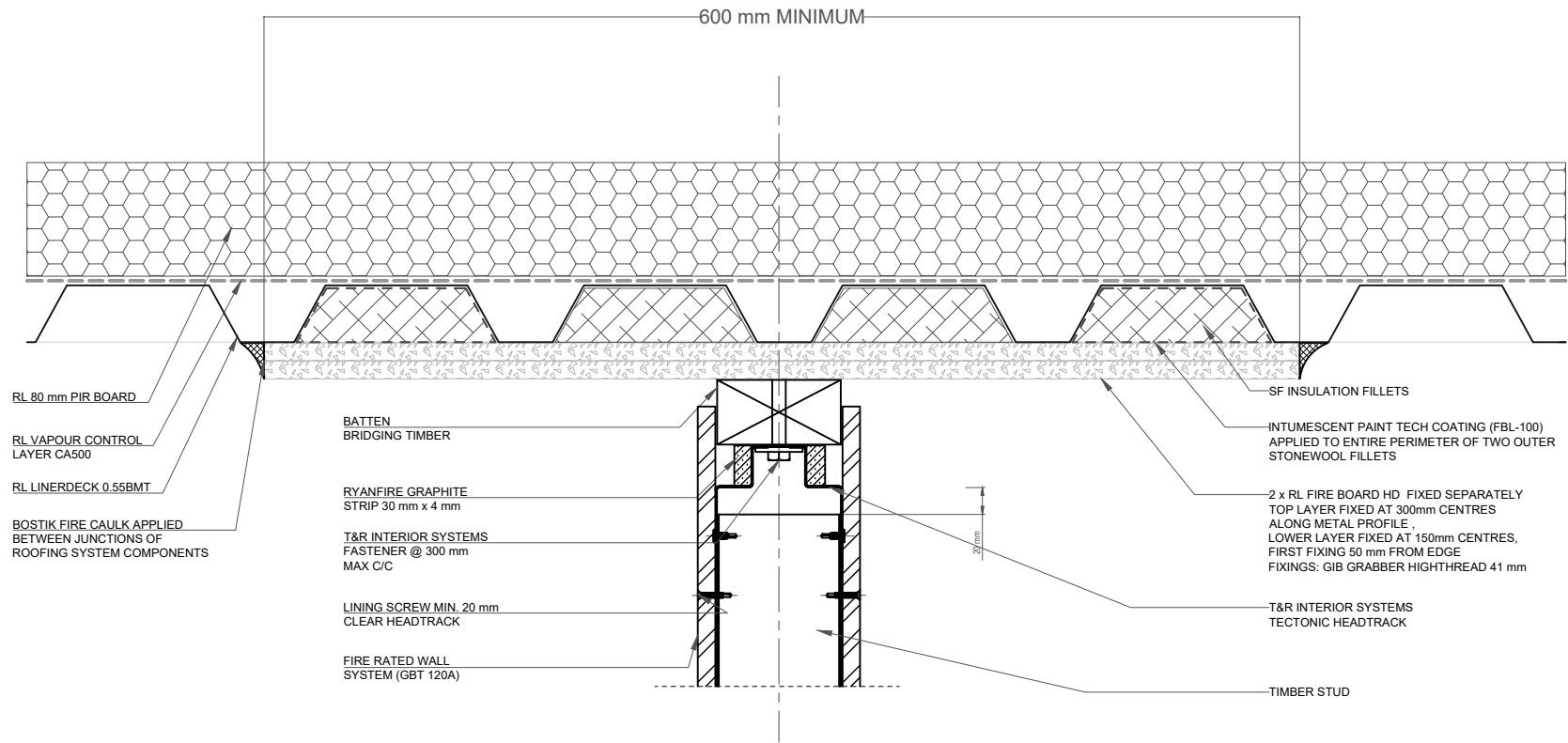

* NOTE: FBL-100 APPLIED TO ENTIRE LENGTH OF BRIDGING TIMBER

AS-BUILT TEST SETUP - PURLINS PARALLEL TO THE WALL

