

ROOFLOGIC SYSTEM:  
ULTRATHERM MSR

DRAWING:  
TYPICAL ROOF - TOP DECK C

DRAWING NUMBER: 105

DRAWN SCALE: NTS

ROOFLOGIC.CO.NZ

This drawing is the copyright of Rooflogic. Modification of details for job specification requirements must be approved by Rooflogic. The building designer is ultimately responsible to ensure all building work is designed and constructed according to Building Code requirements, NZ standards and best code of practice industry guidelines. All components must be supplied by Rooflogic. Rooflogic reserves the right to alter or upgrade details at any time without prior notice.

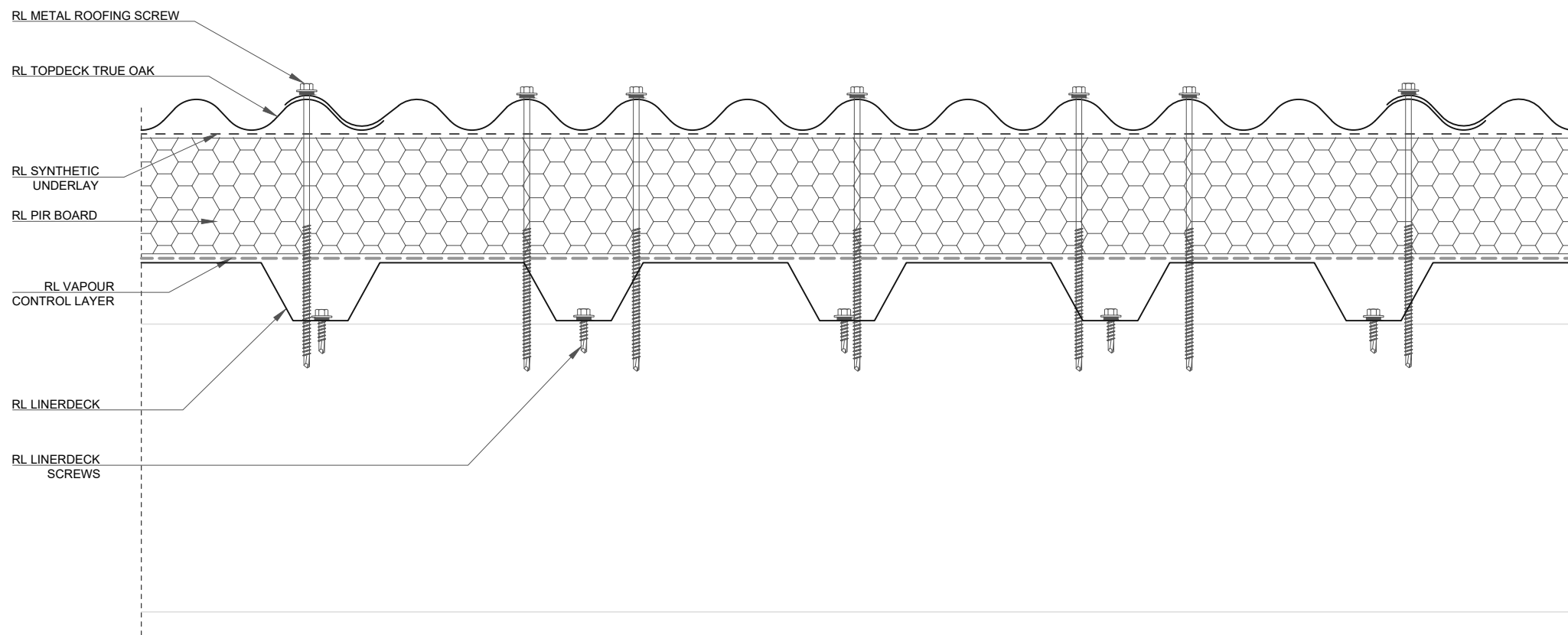



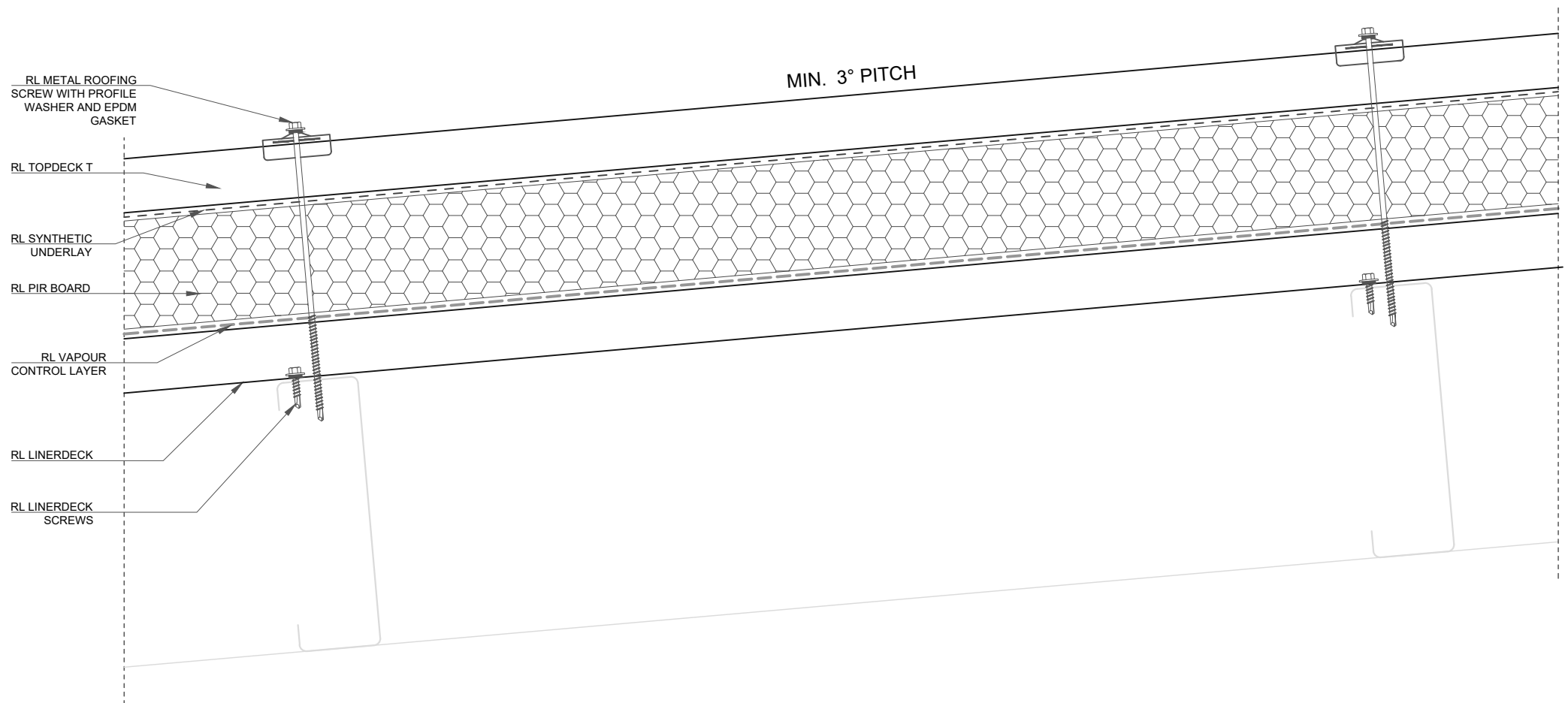

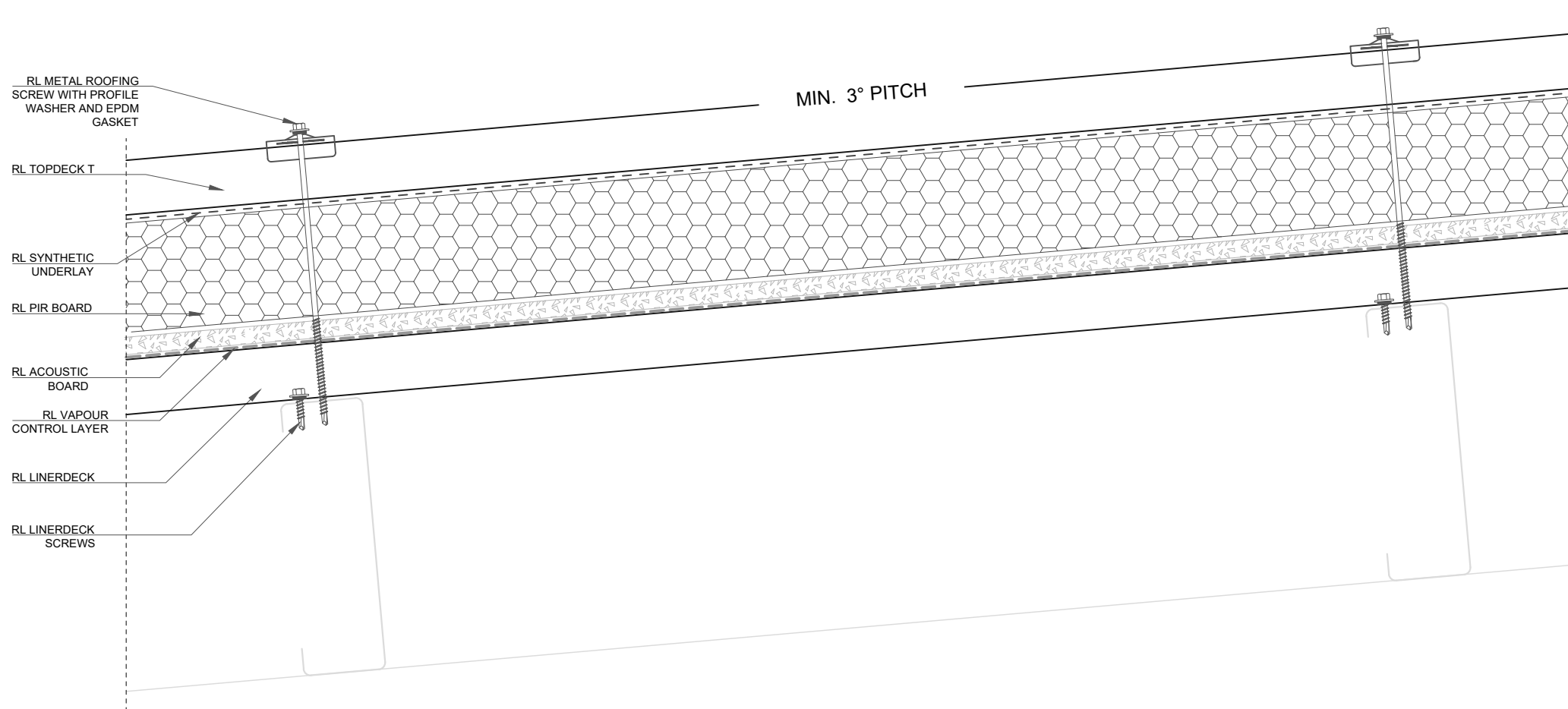

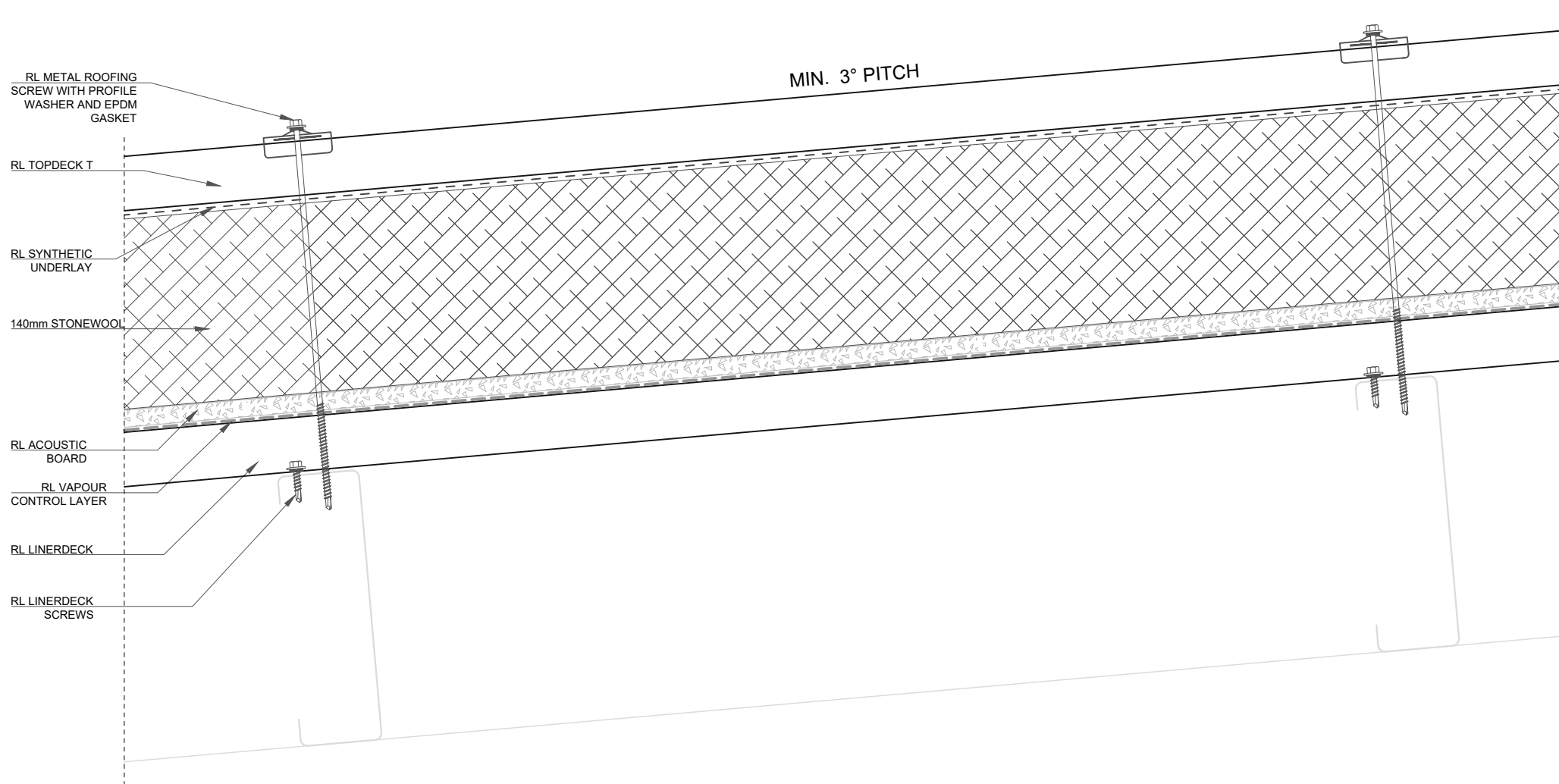

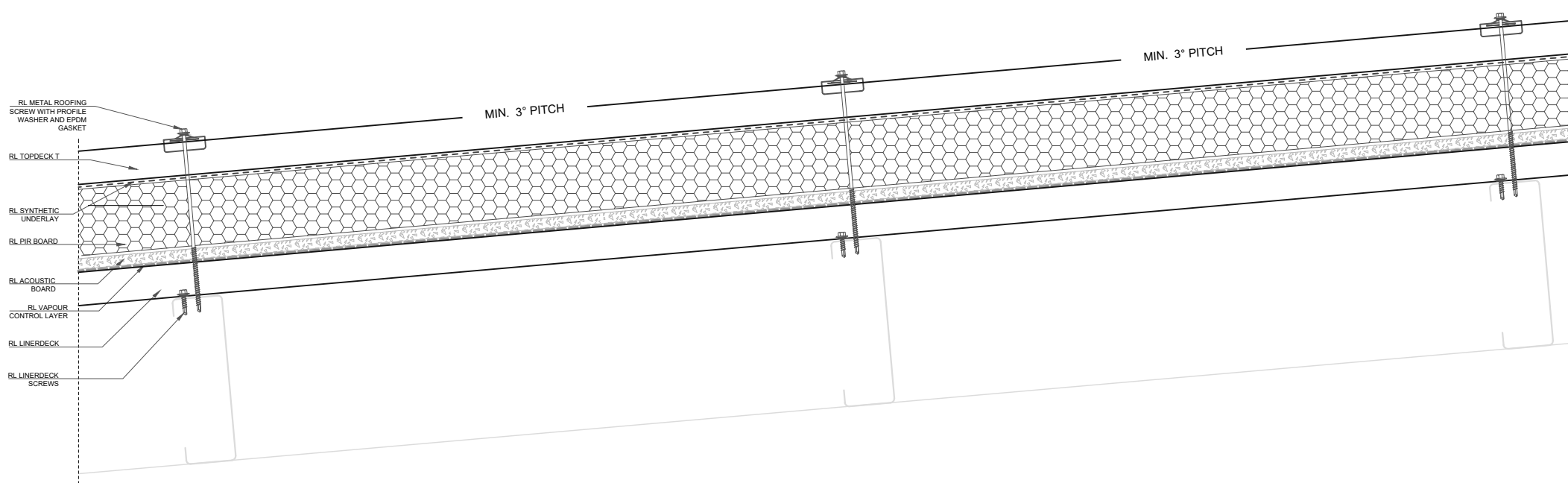

ROOFLOGIC SYSTEM:  
ULTRATHERM MSR

DRAWING:  
TYPICAL ROOF CROSS-SECTION  
WITH ACOUSTIC BOARD

DRAWING NUMBER: 201 C

DRAWN SCALE: NTS

ROOFLOGIC.CO.NZ

This drawing is the copyright of Rooflogic. Modification of details for job specification requirements must be approved by Rooflogic. The building designer is ultimately responsible to ensure all building work is designed and constructed according to Building Code requirements, NZ standards and best code of practice industry guidelines. All components must be supplied by Rooflogic. Rooflogic reserves the right to alter or upgrade details at any time without prior notice.

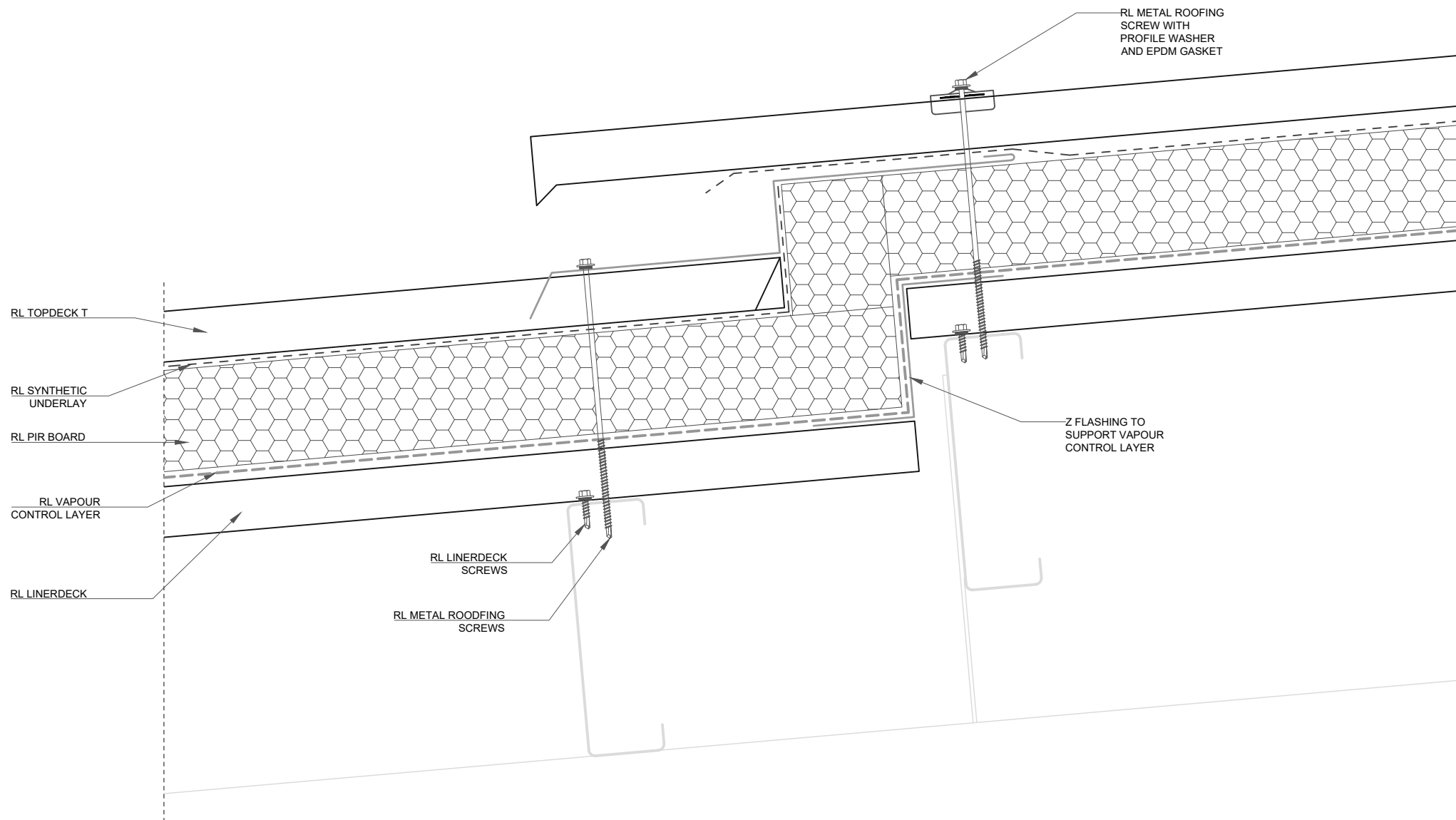

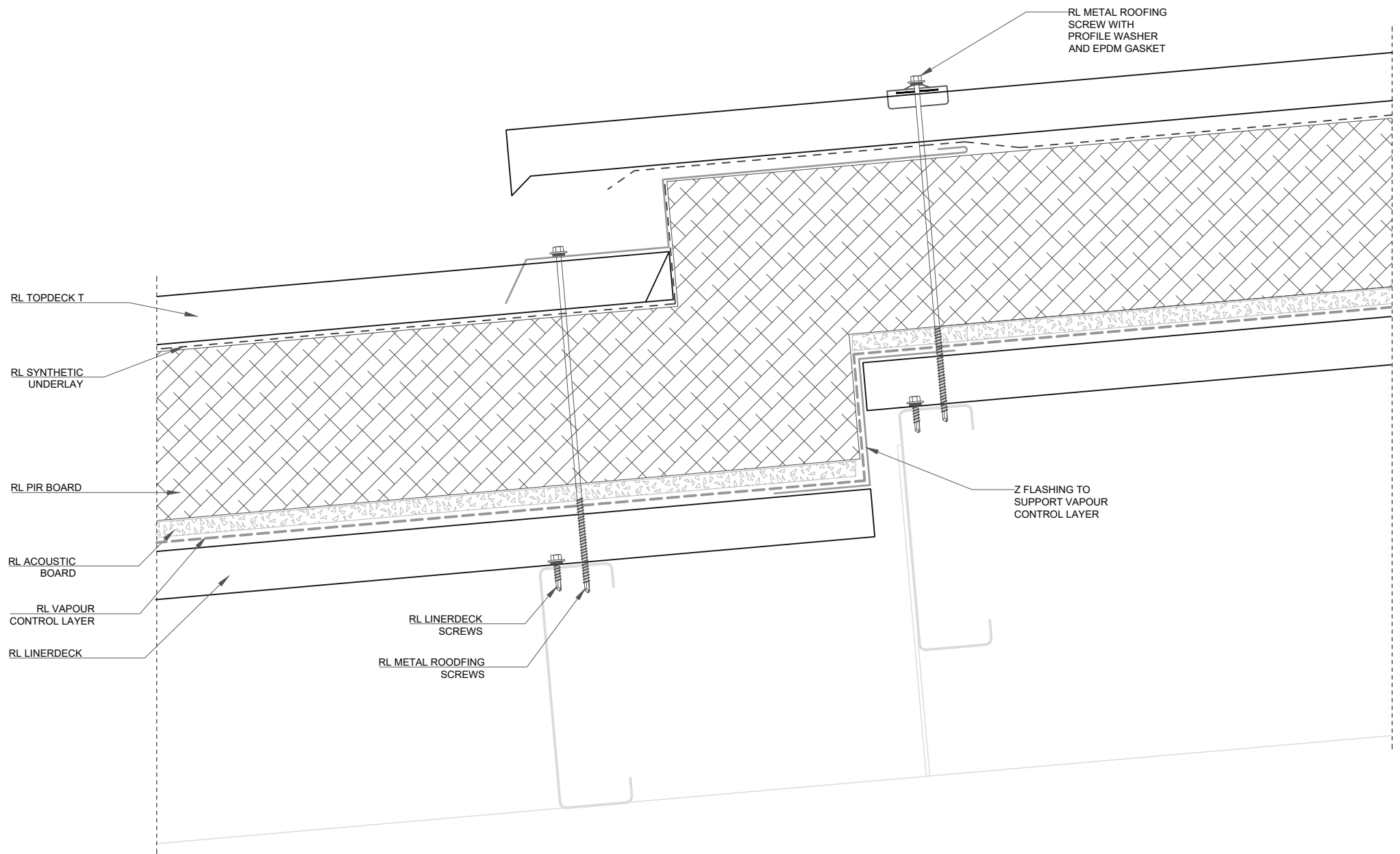

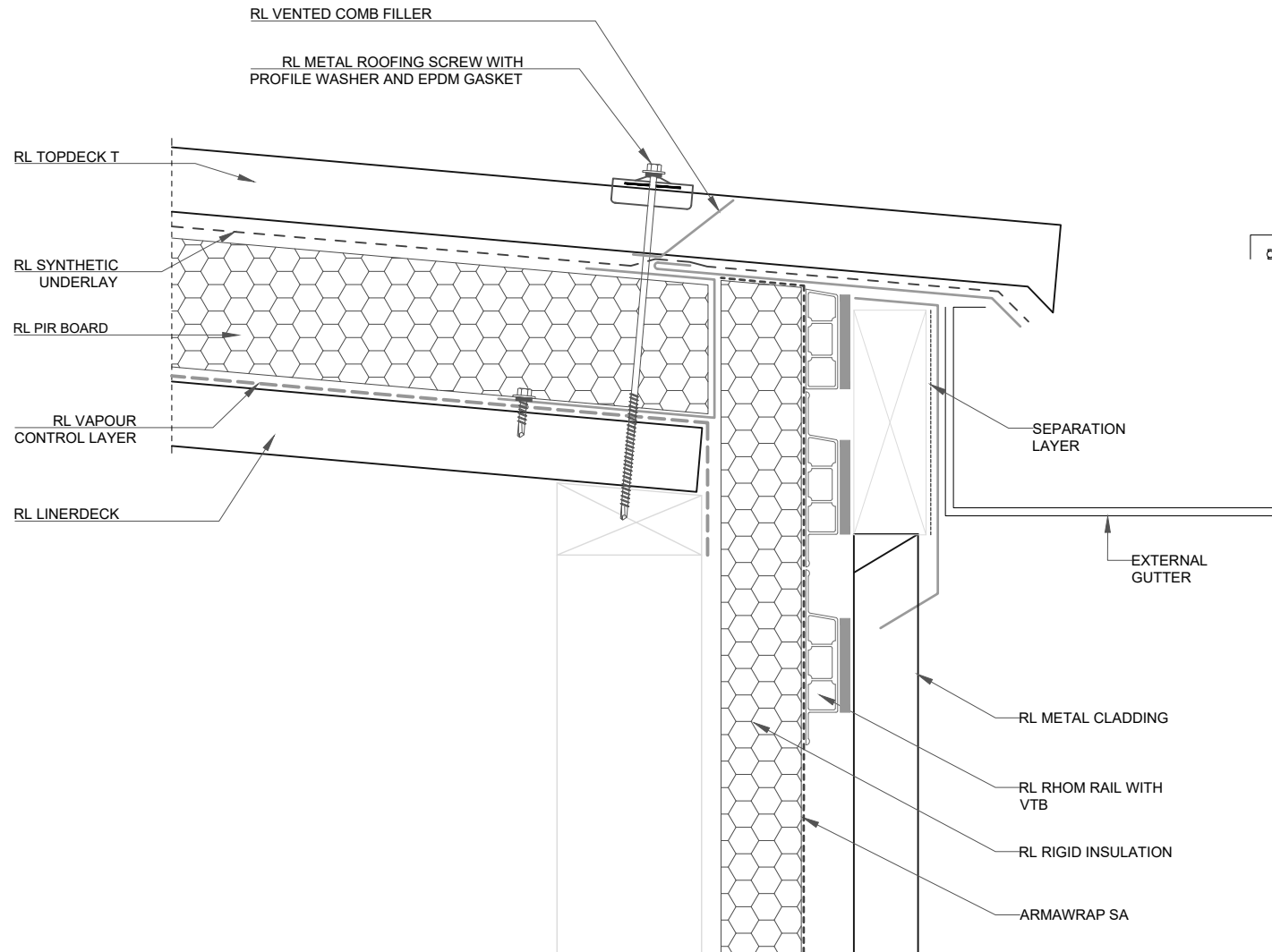

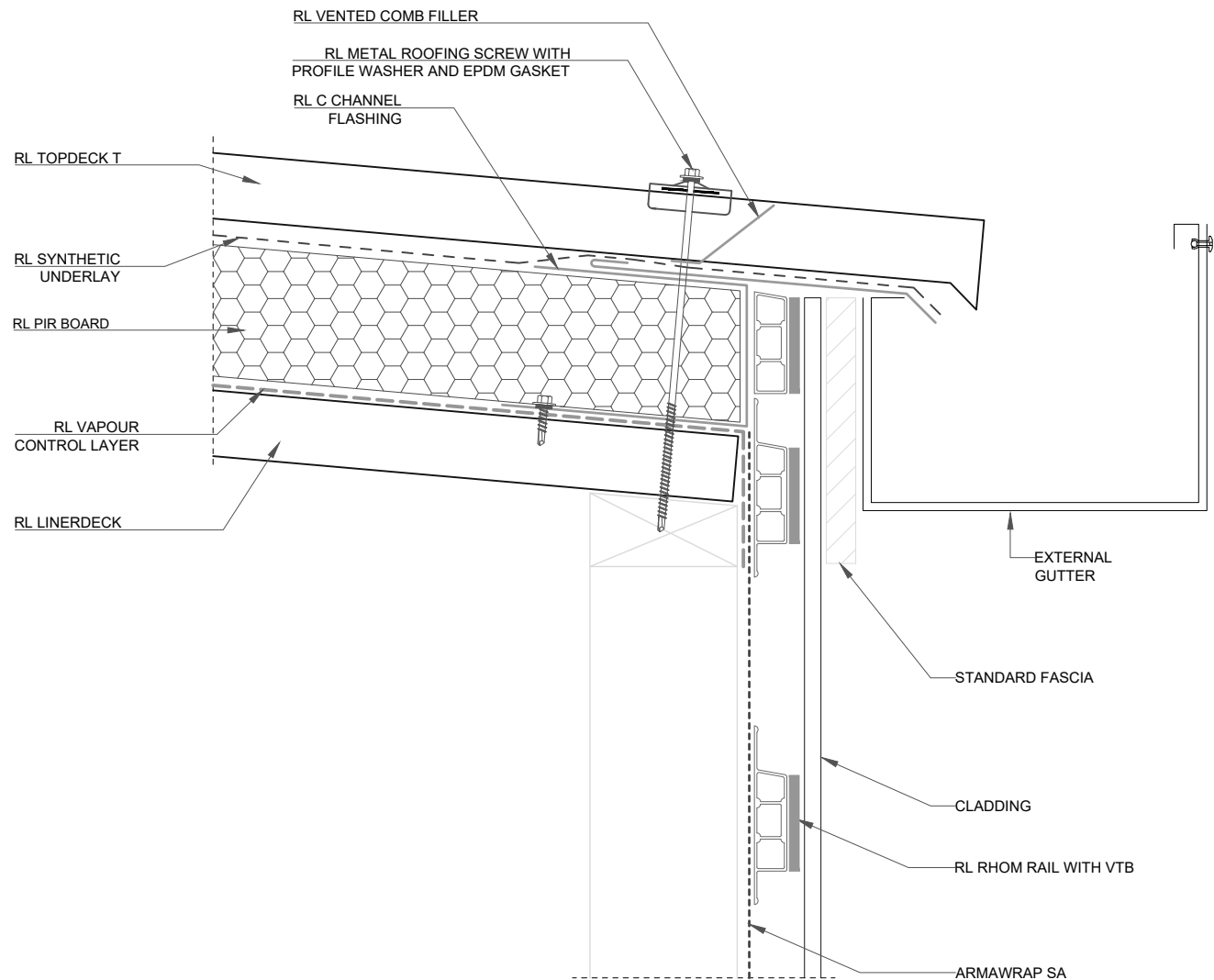



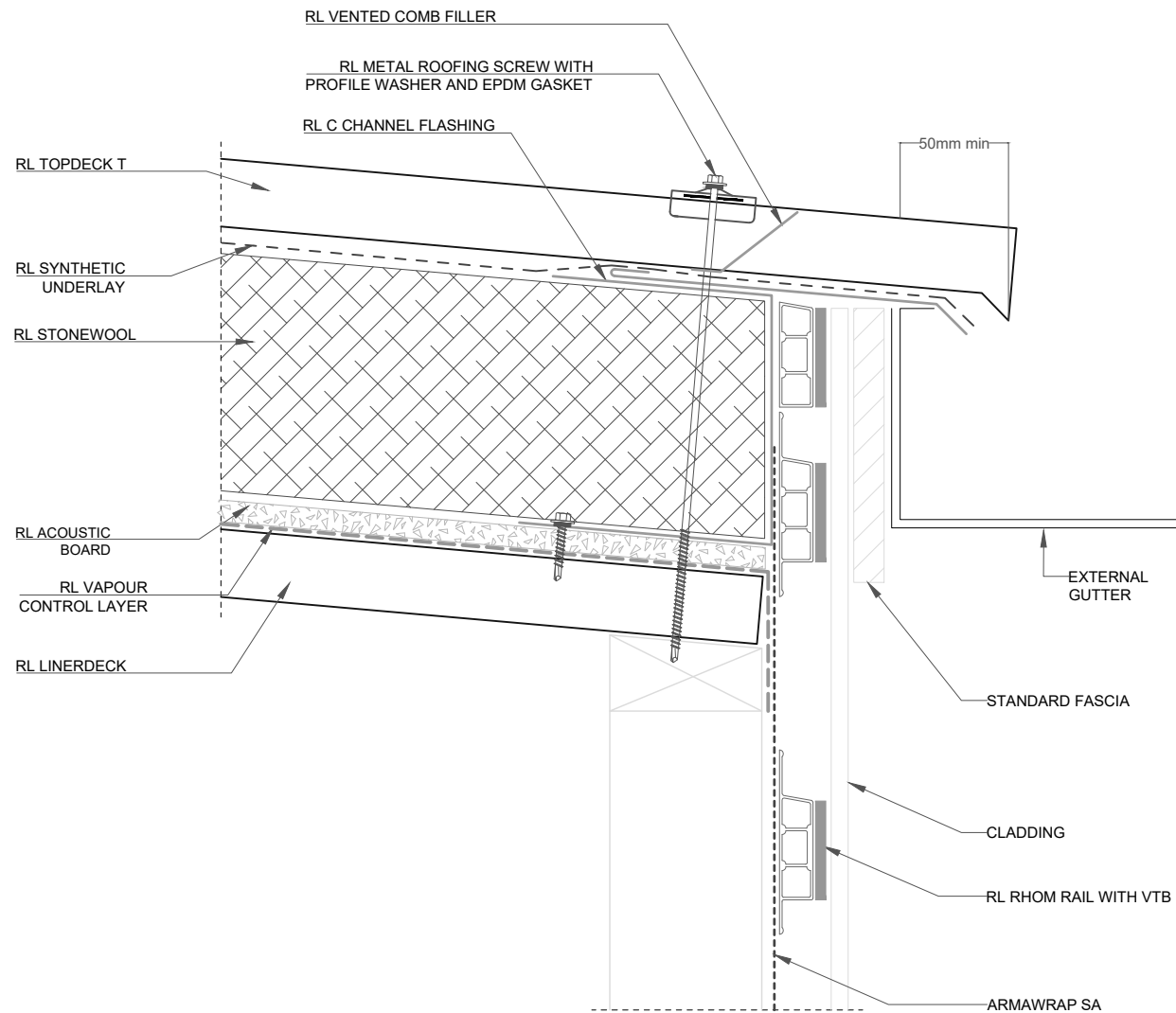

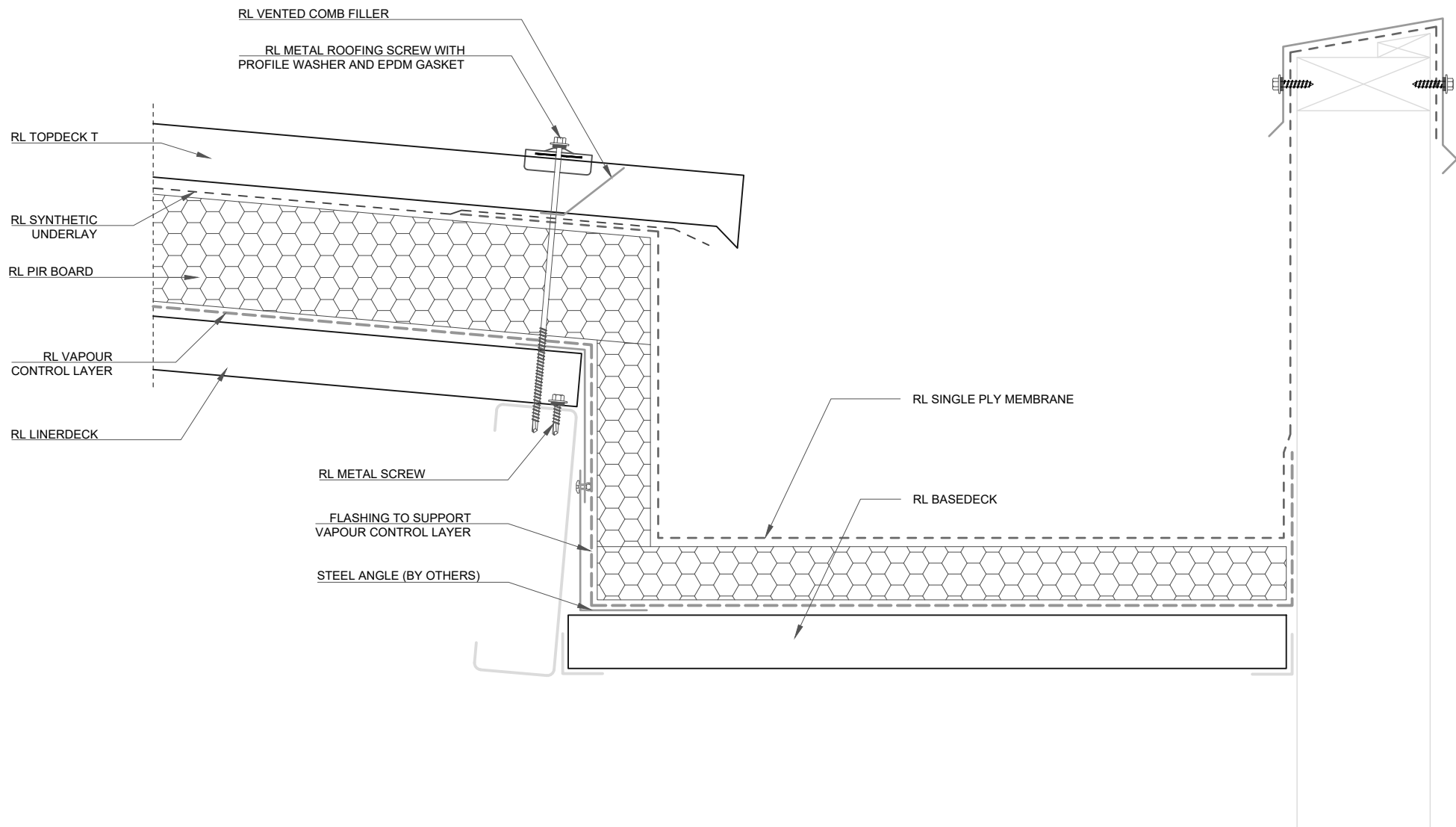

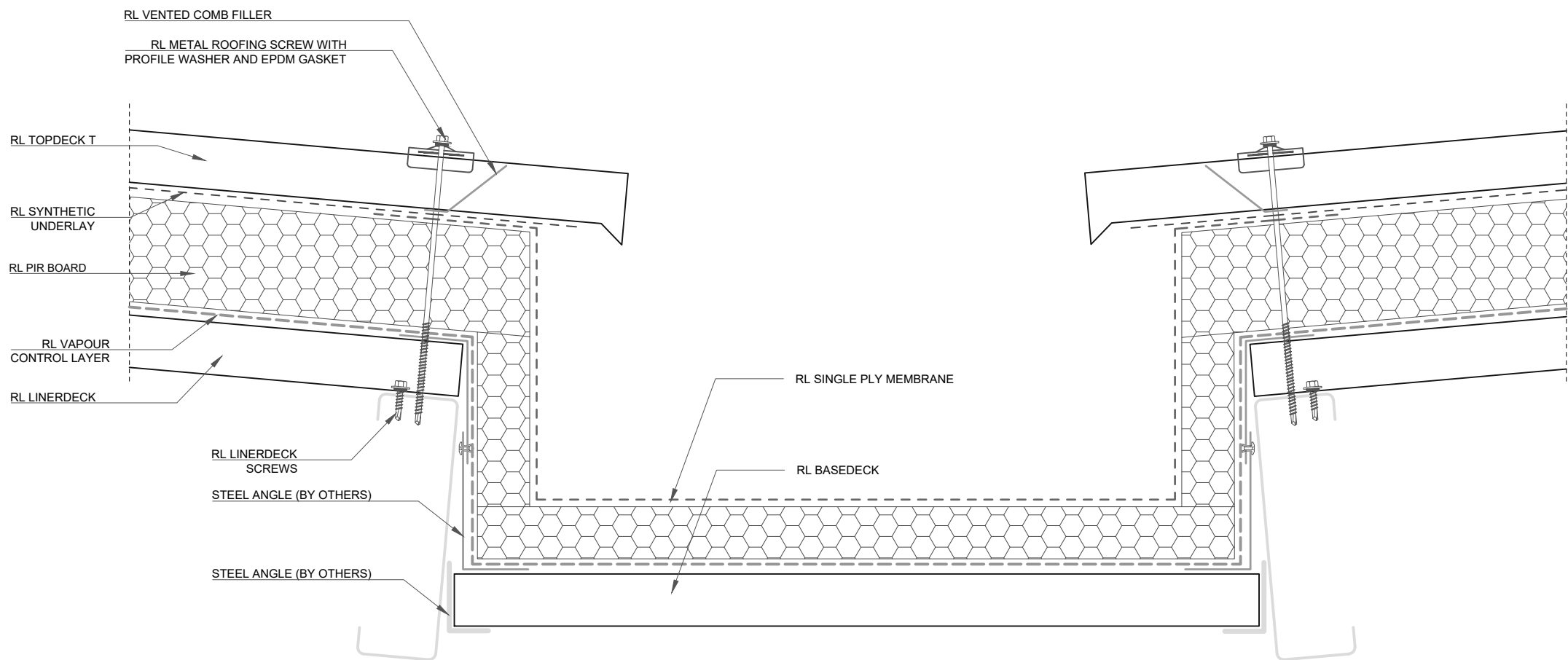

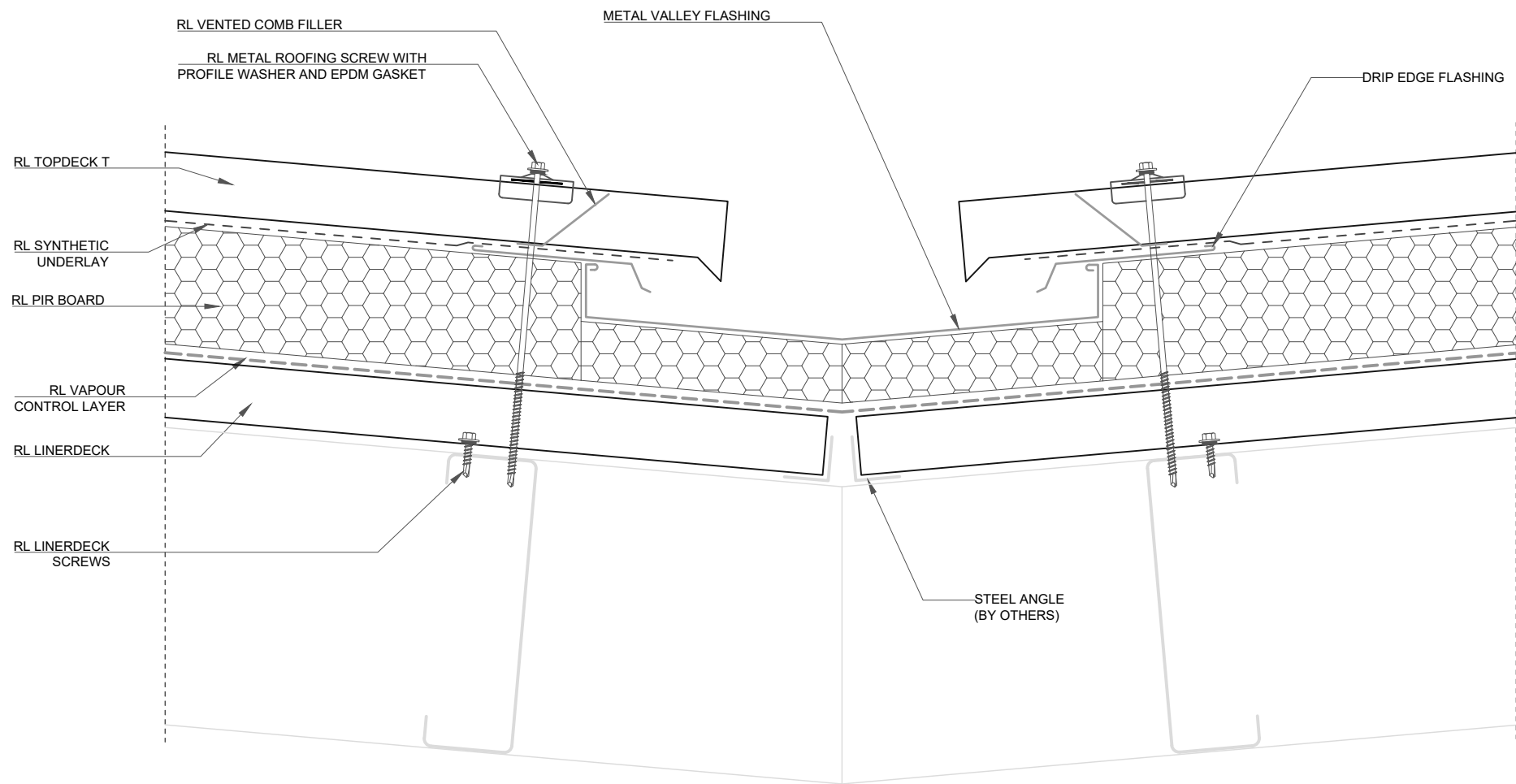

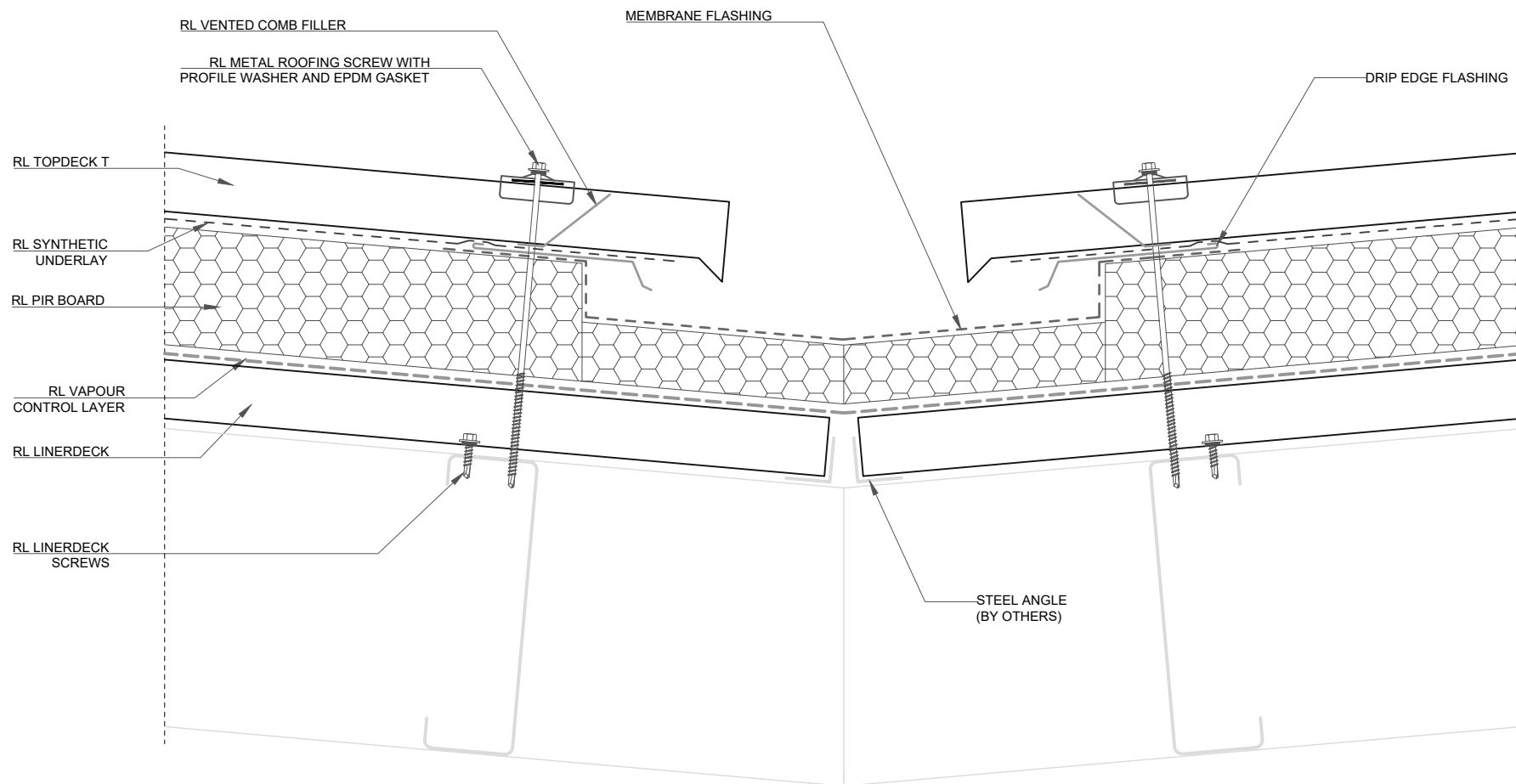

SQUARE TOP RIDGE  
FLASHING PURPOSE  
MADE TO MATCH  
ROOF PITCH

RL METAL ROOFING  
SCREW

RL TOPDECK T

RL SYNTHETIC  
UNDERLAY

RL PIR BOARD

RL VAPOUR  
CONTROL LAYER

RL LINERDECK

RL LINERDECK  
SCREWS



ROOFLOGIC SYSTEM:  
ULTRATHERM MSR

DRAWING:  
TYPICAL RIDGE

DRAWING NUMBER: 400

DRAWN SCALE: NTS

ROOFLOGIC.CO.NZ

This drawing is the copyright of Rooflogic. Modification of details for job specification requirements must be approved by Rooflogic. The building designer is ultimately responsible to ensure all building work is designed and constructed according to Building Code requirements, NZ standards and best code of practice industry guidelines. All components must be supplied by Rooflogic. Rooflogic reserves the right to alter or upgrade details at any time without prior notice.

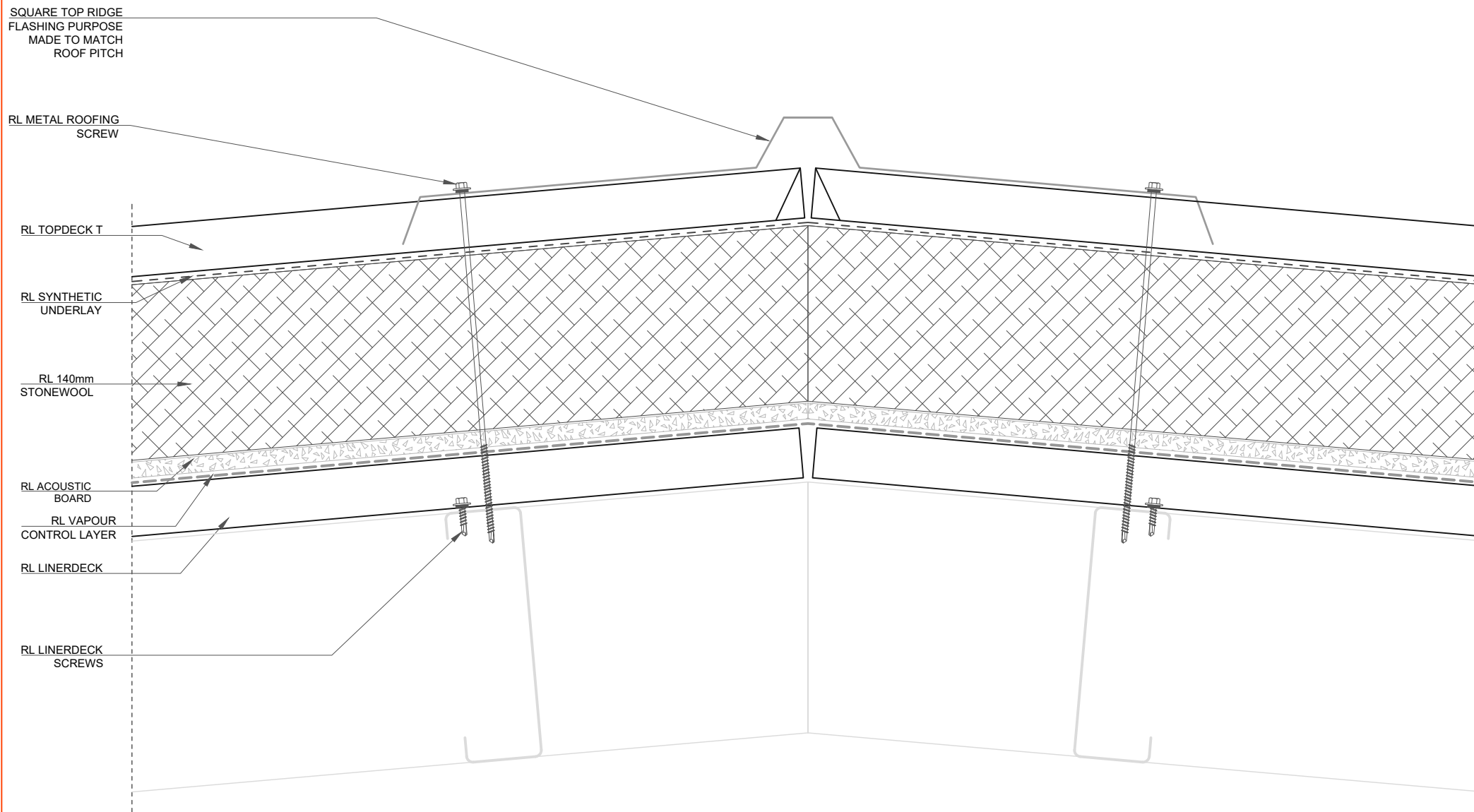

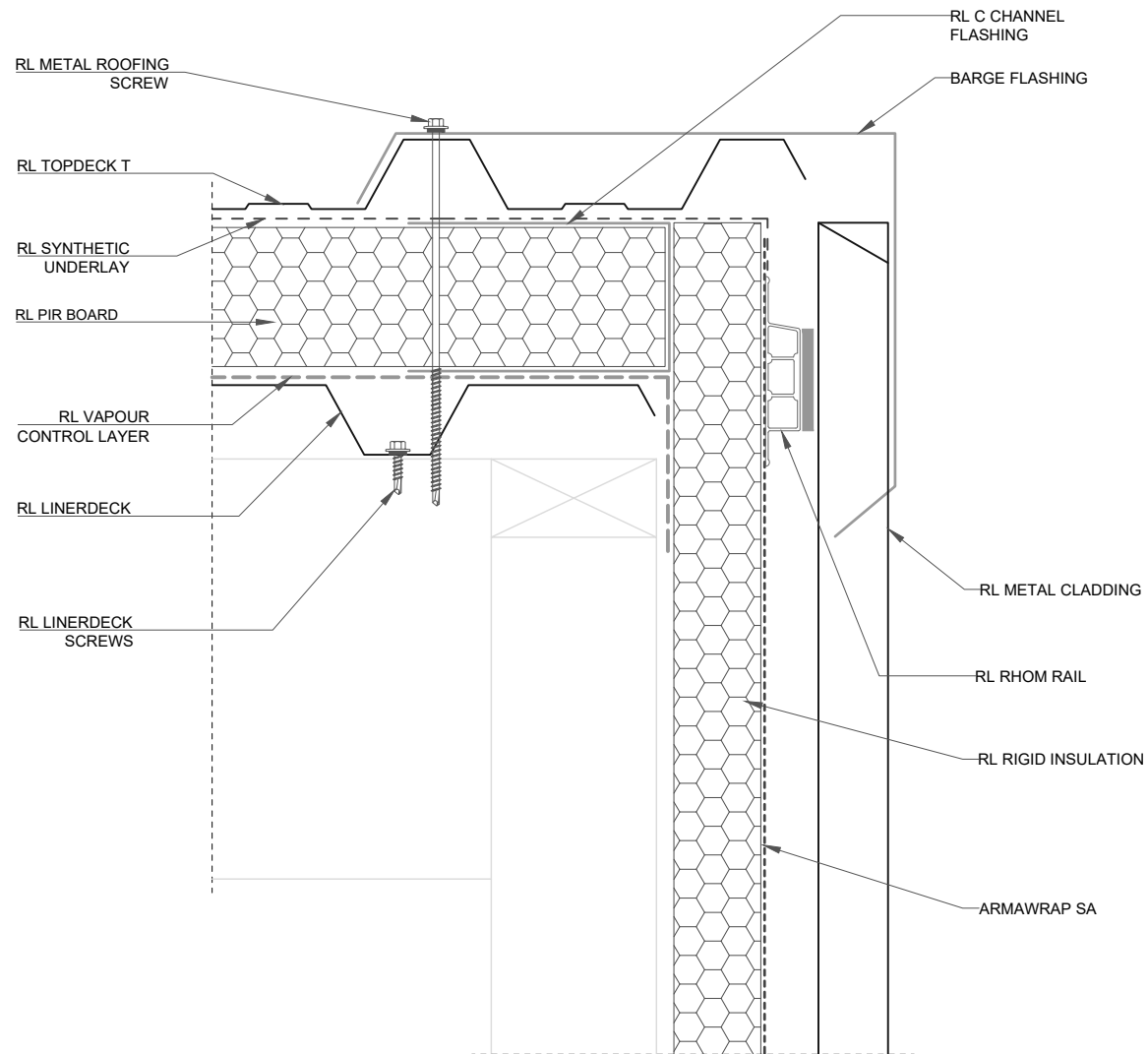



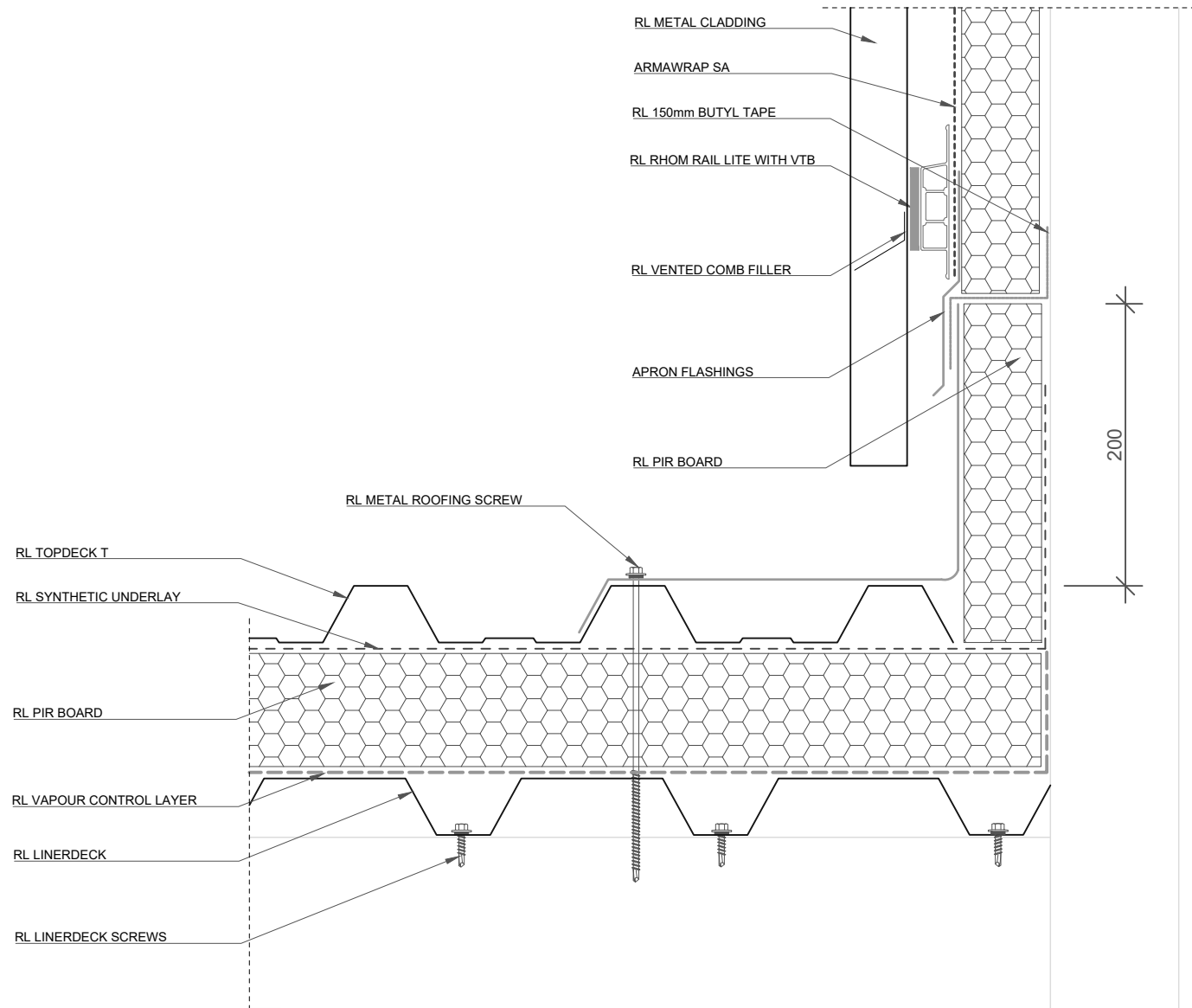

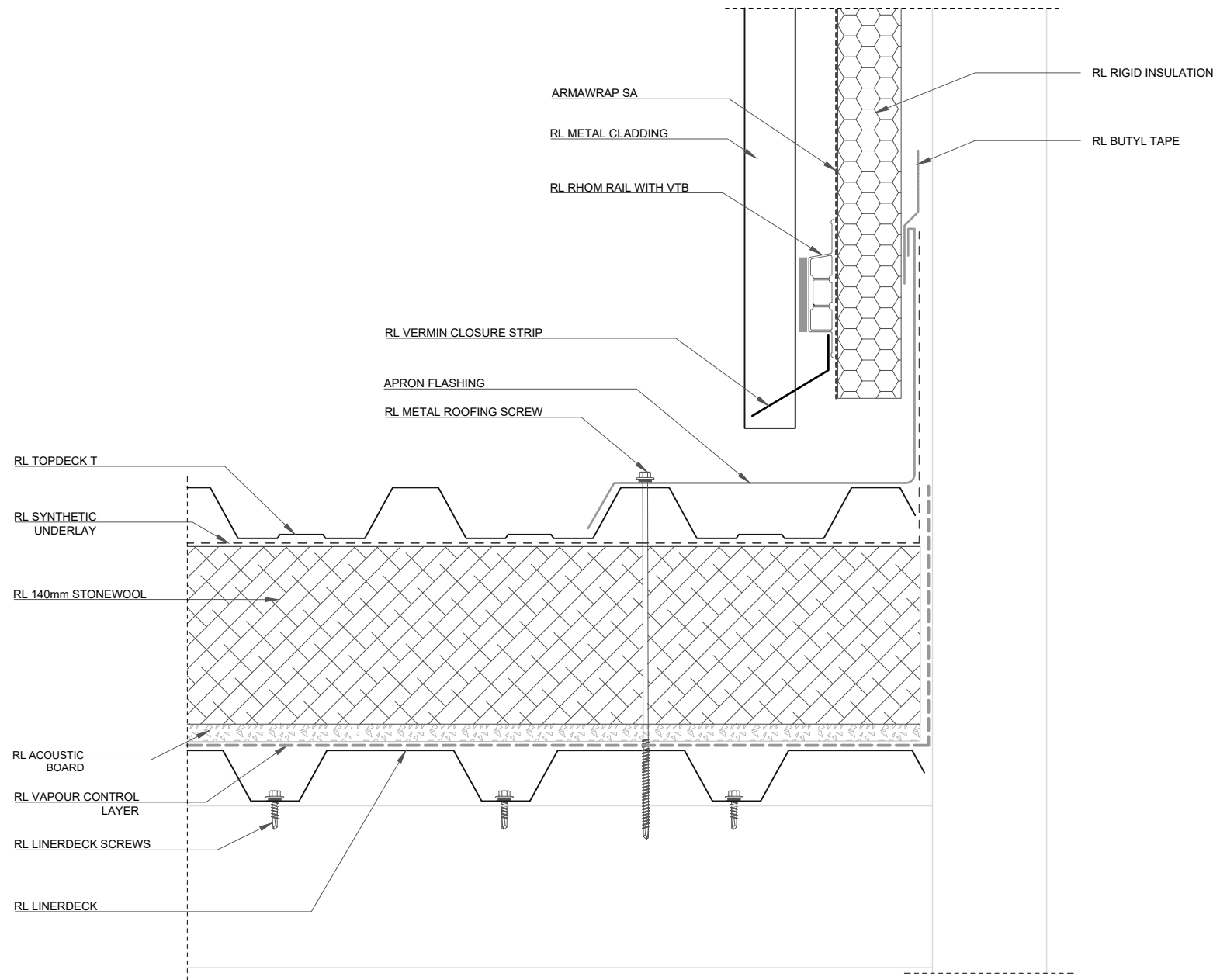

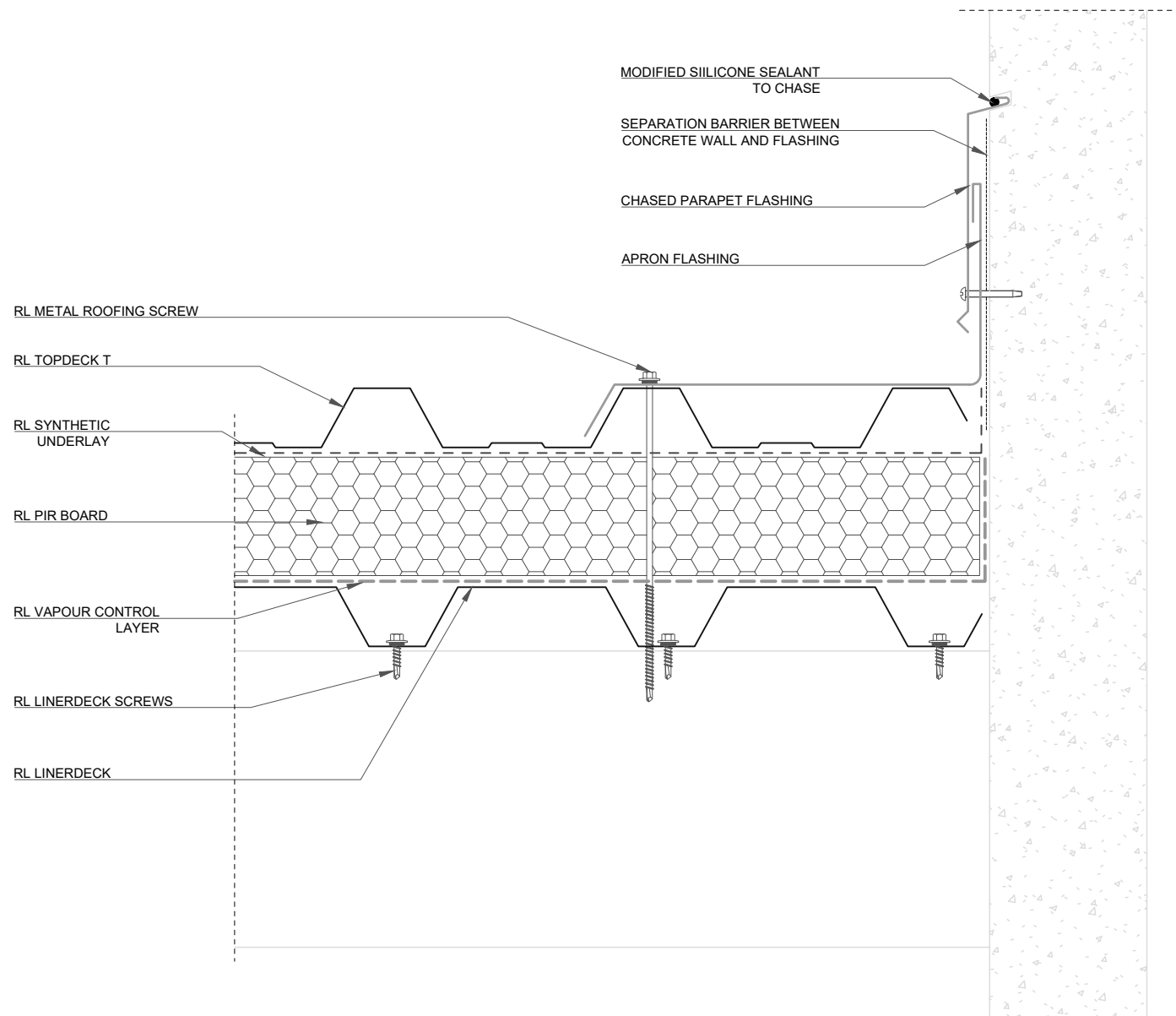

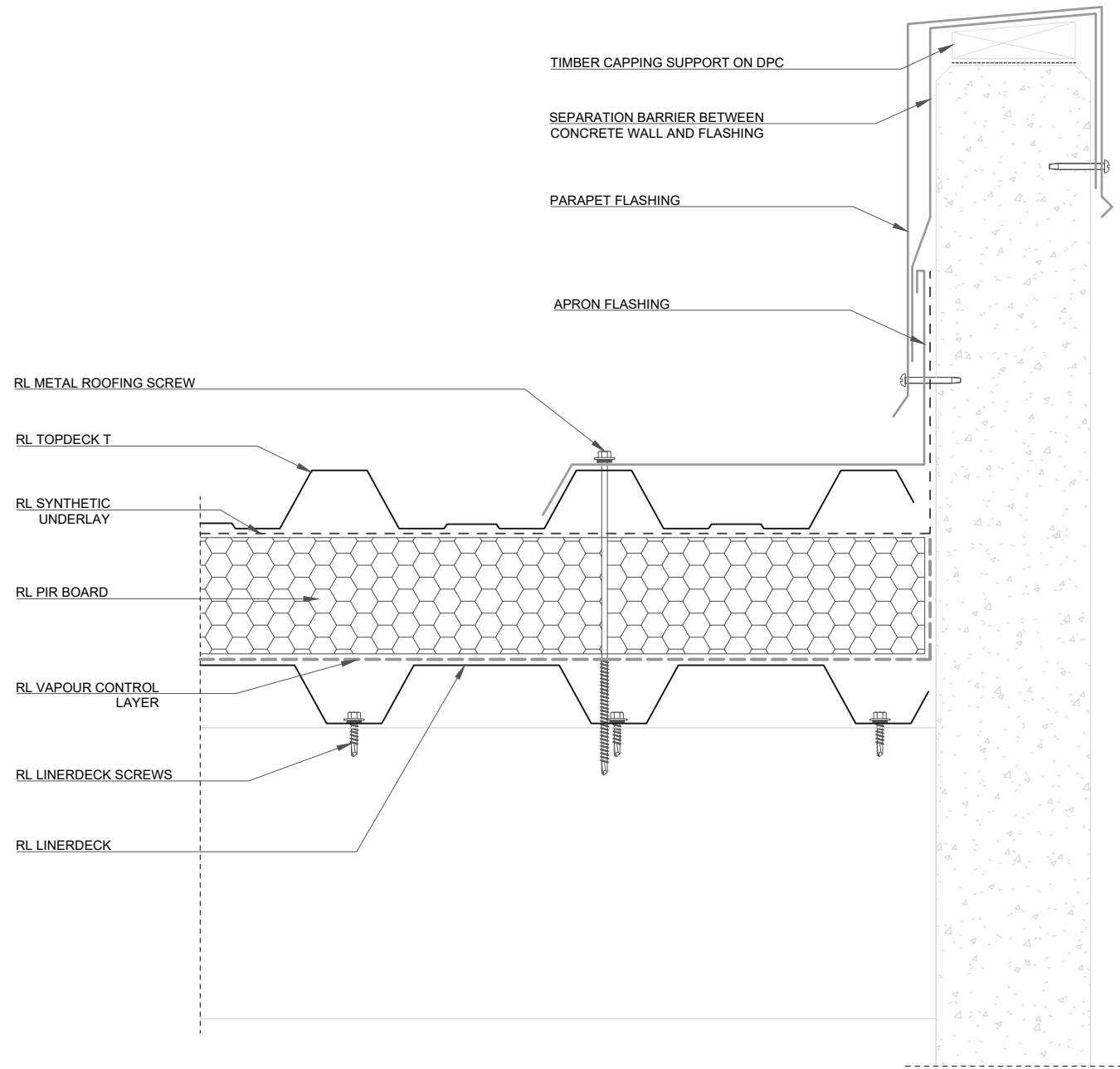

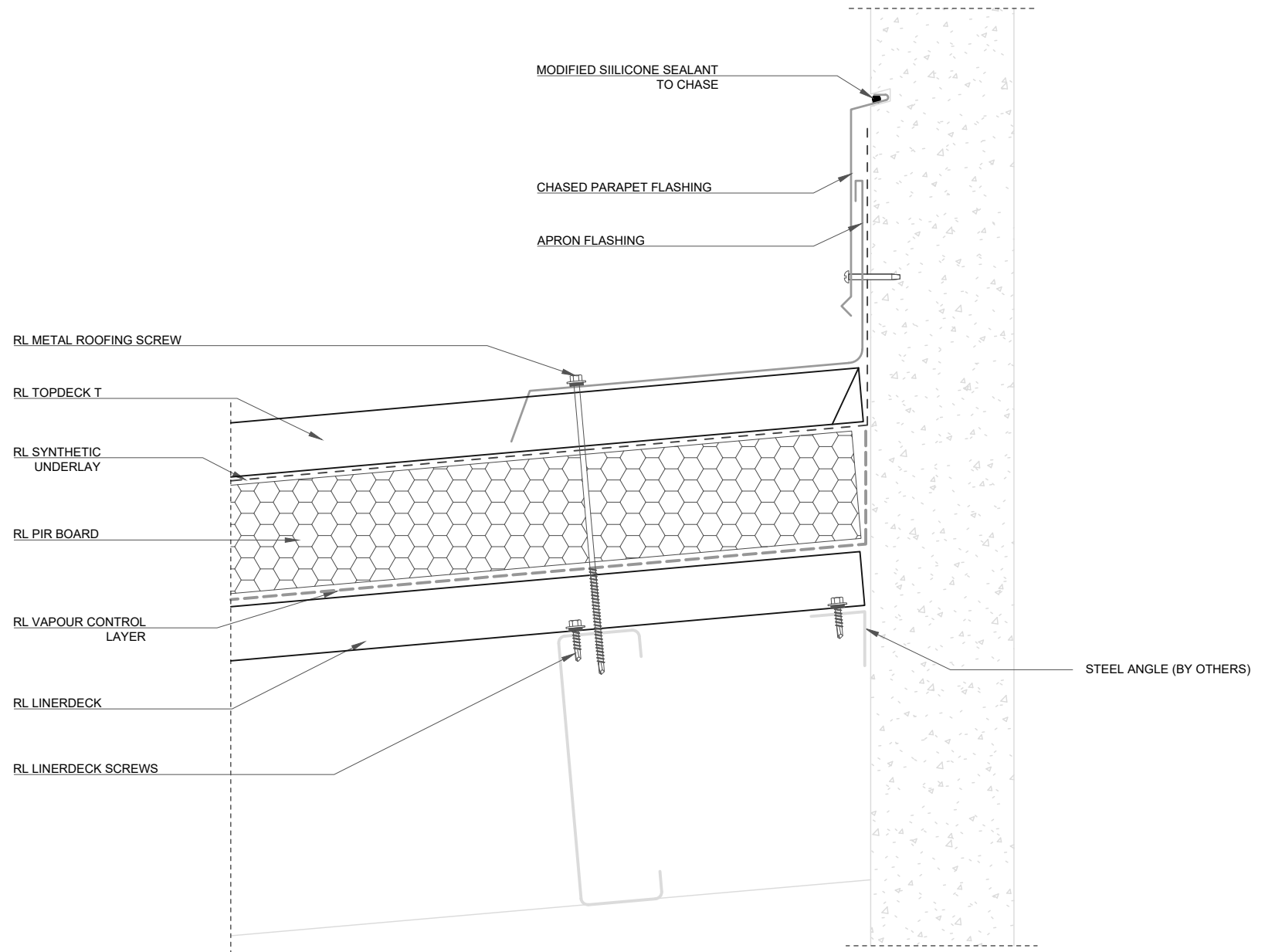

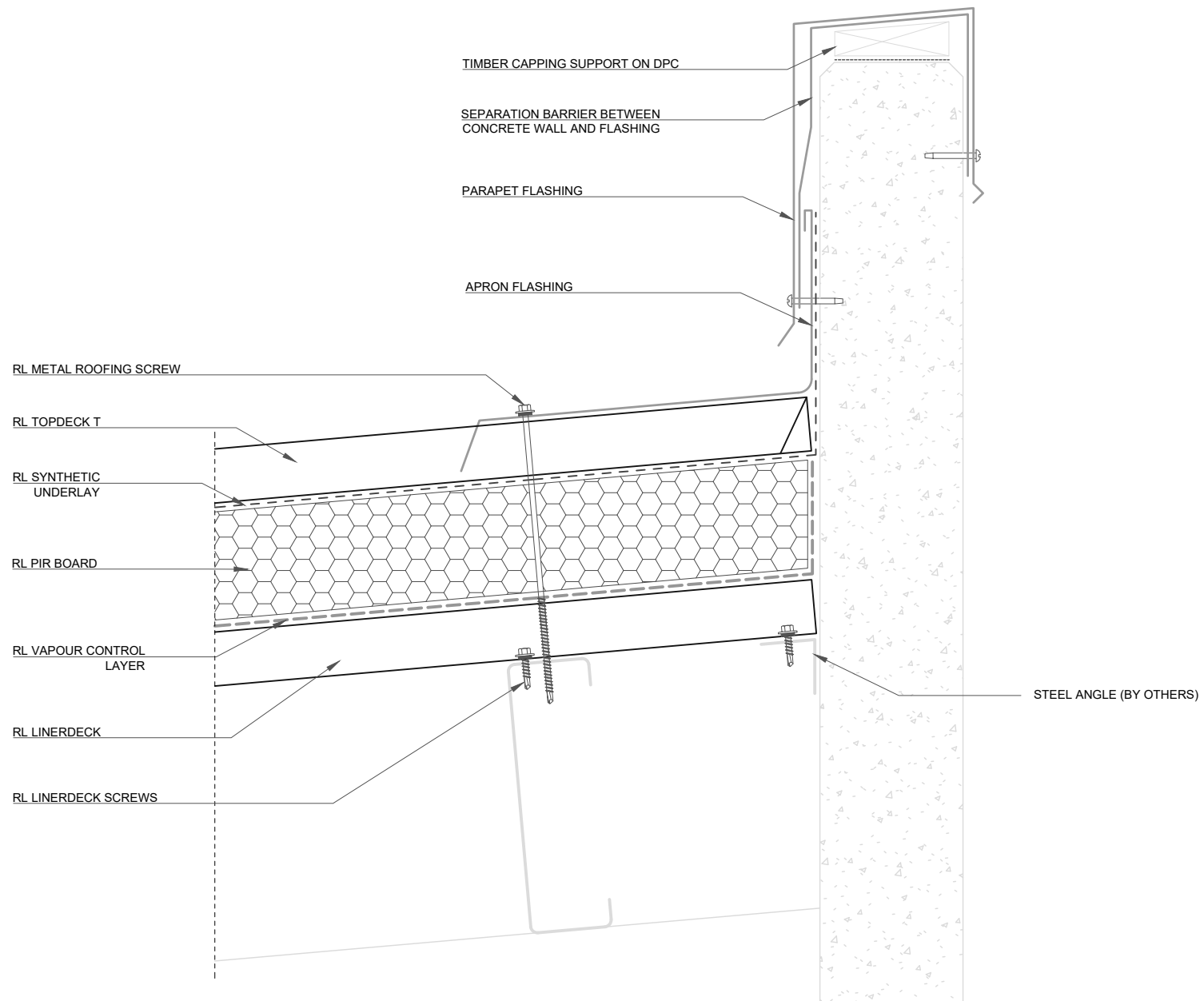

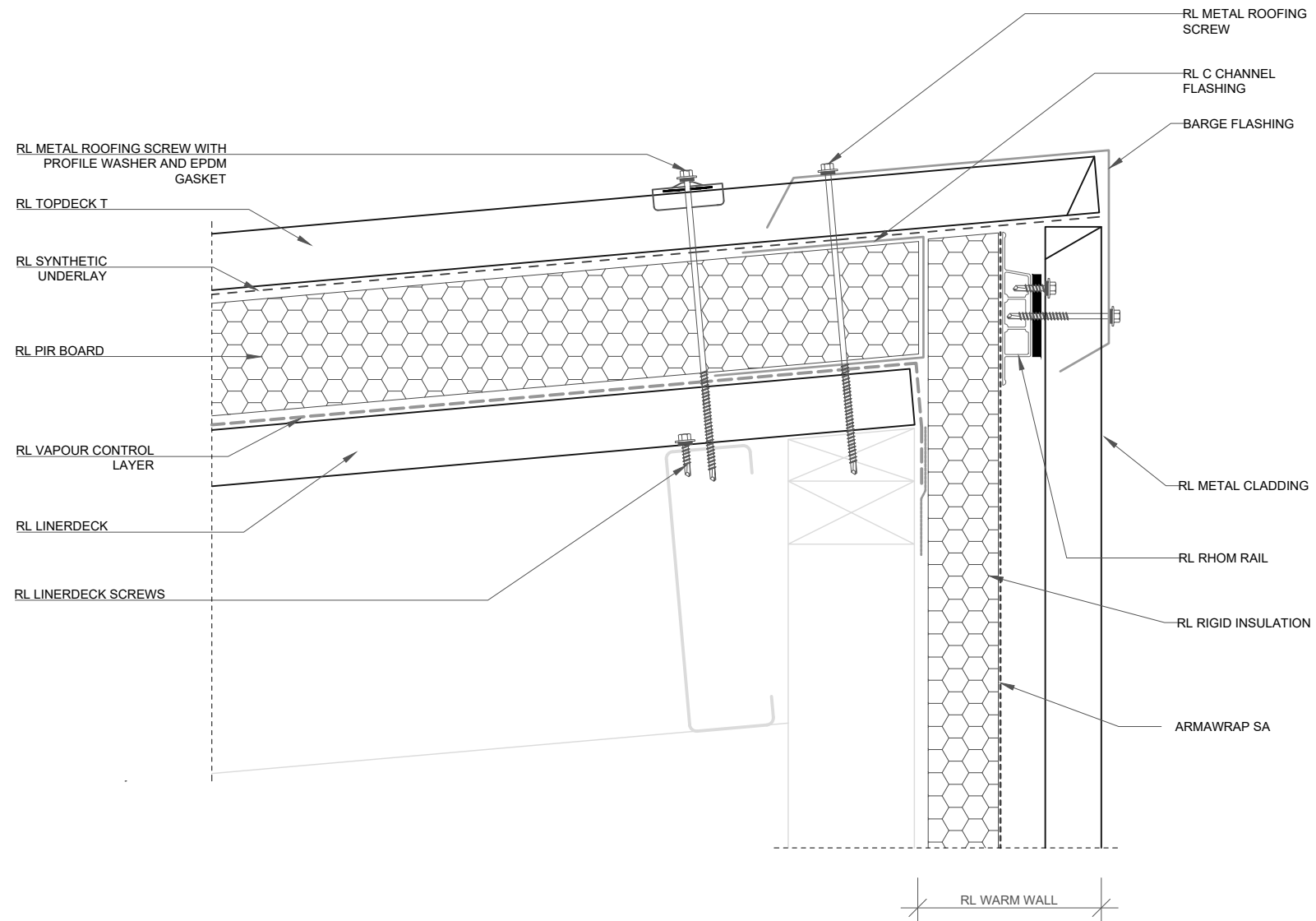

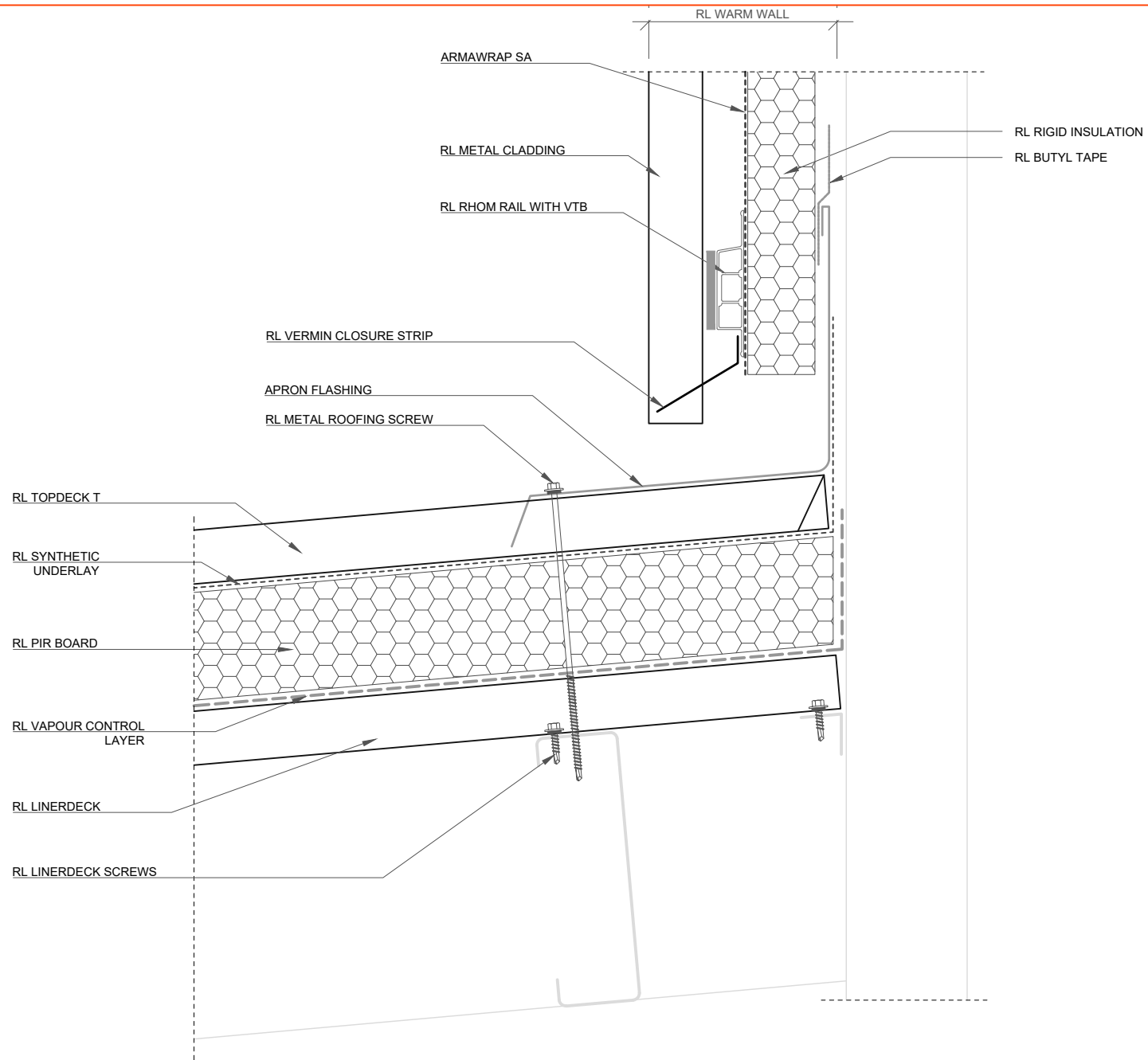



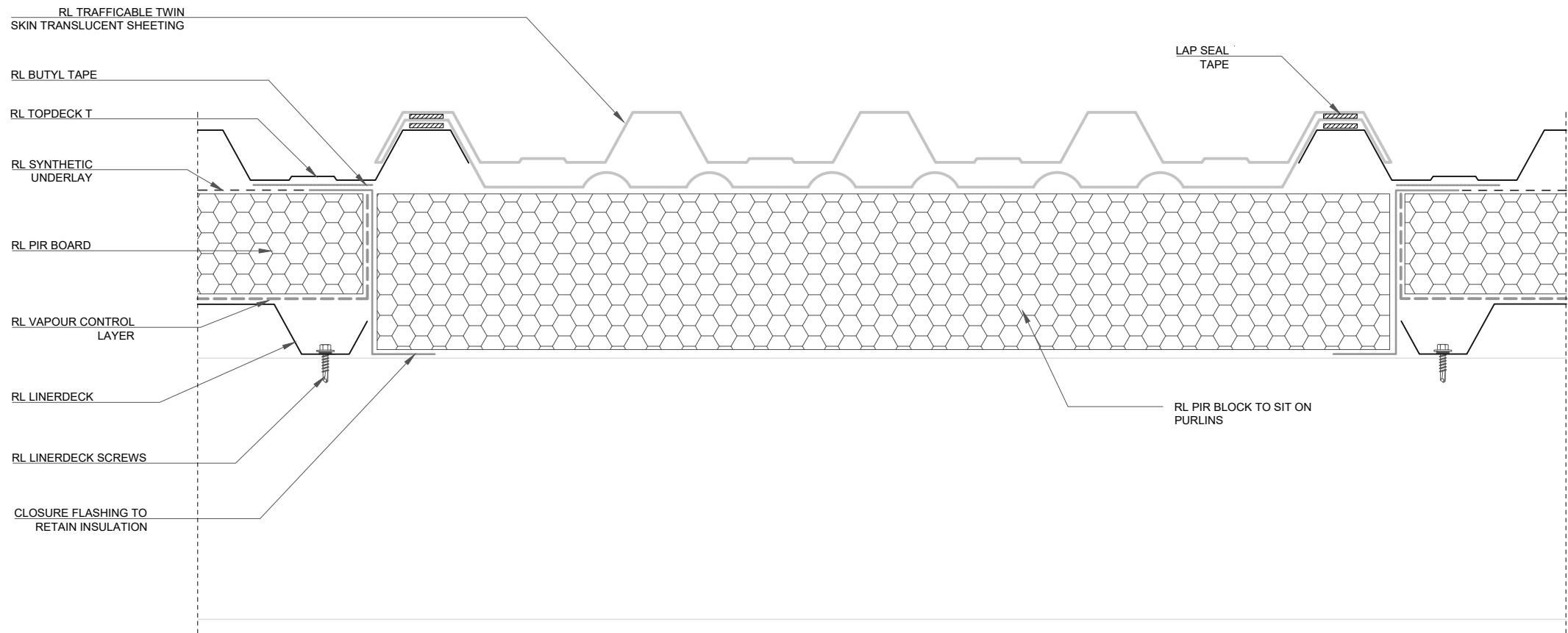

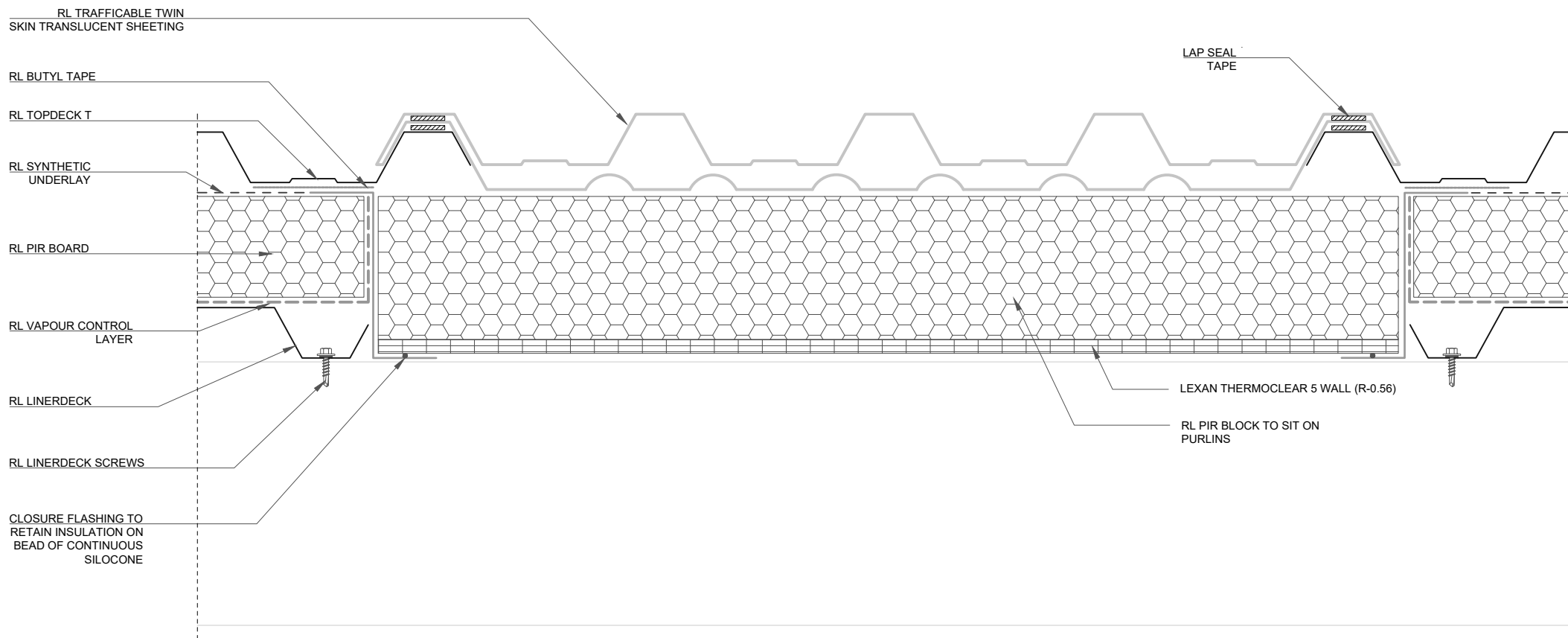

AS-BUILT TEST SETUP - PURLINS PERPENDICULAR TO THE WALL

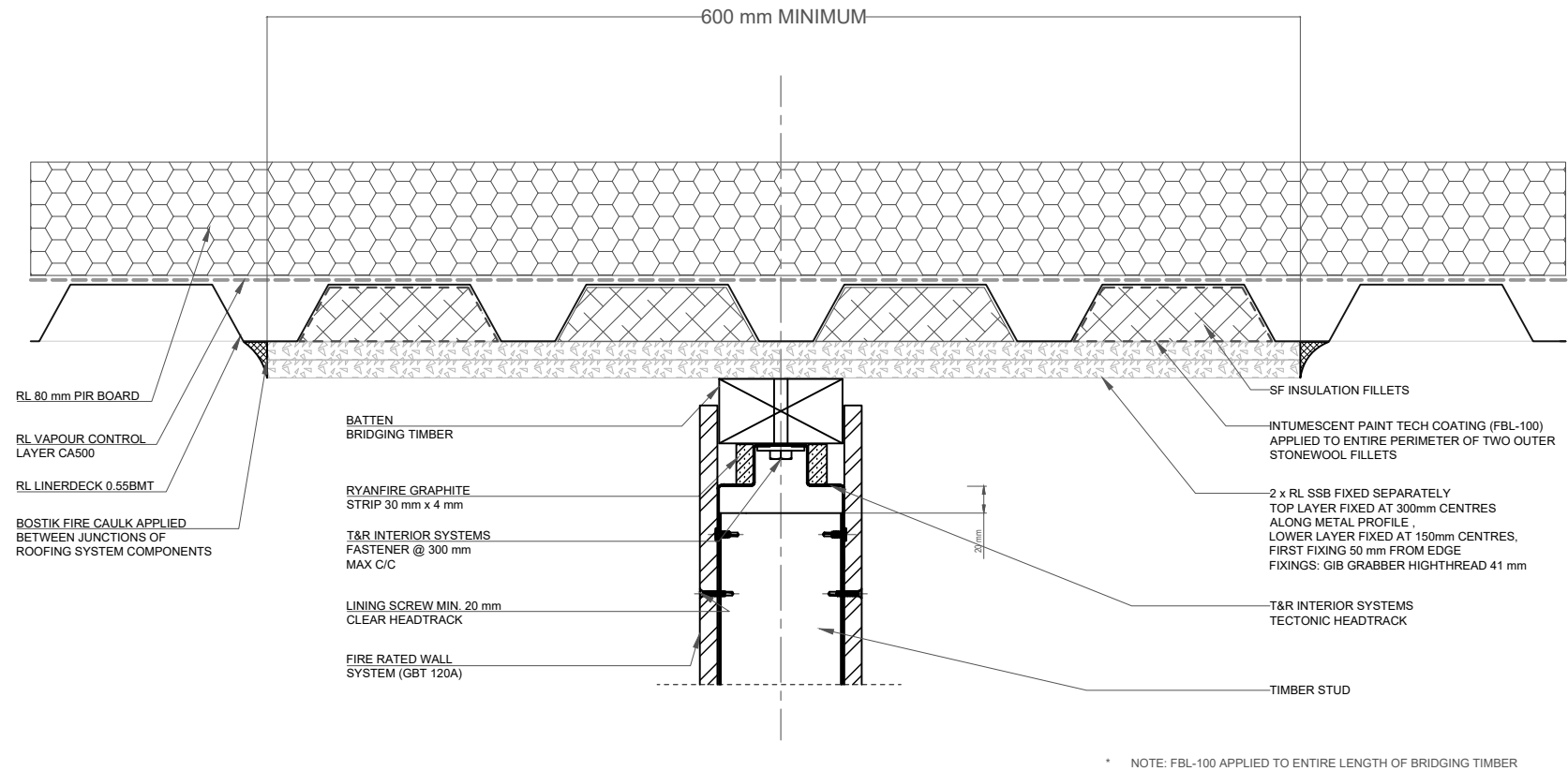

AS-BUILT TEST SETUP - PURLINS PARALLEL TO THE WALL

